

REV	DATE	BY	DESCRIPTION
-	24.10.2018	PW	Surce SBPN353500_D, change of concept
A	08.01.2019	PW	Change design
B	25.08.2029	PW	Changing the magnet weld assy
C	13.03.2020	PW	Changing the size of the screw on deflector
D	25.08.2023	PW	Magnetic system update
E	05.01.2024	PW	Changing the magnet shell
F	26.09.2024	PW	Modified extractor, 10000Gs on boost plate

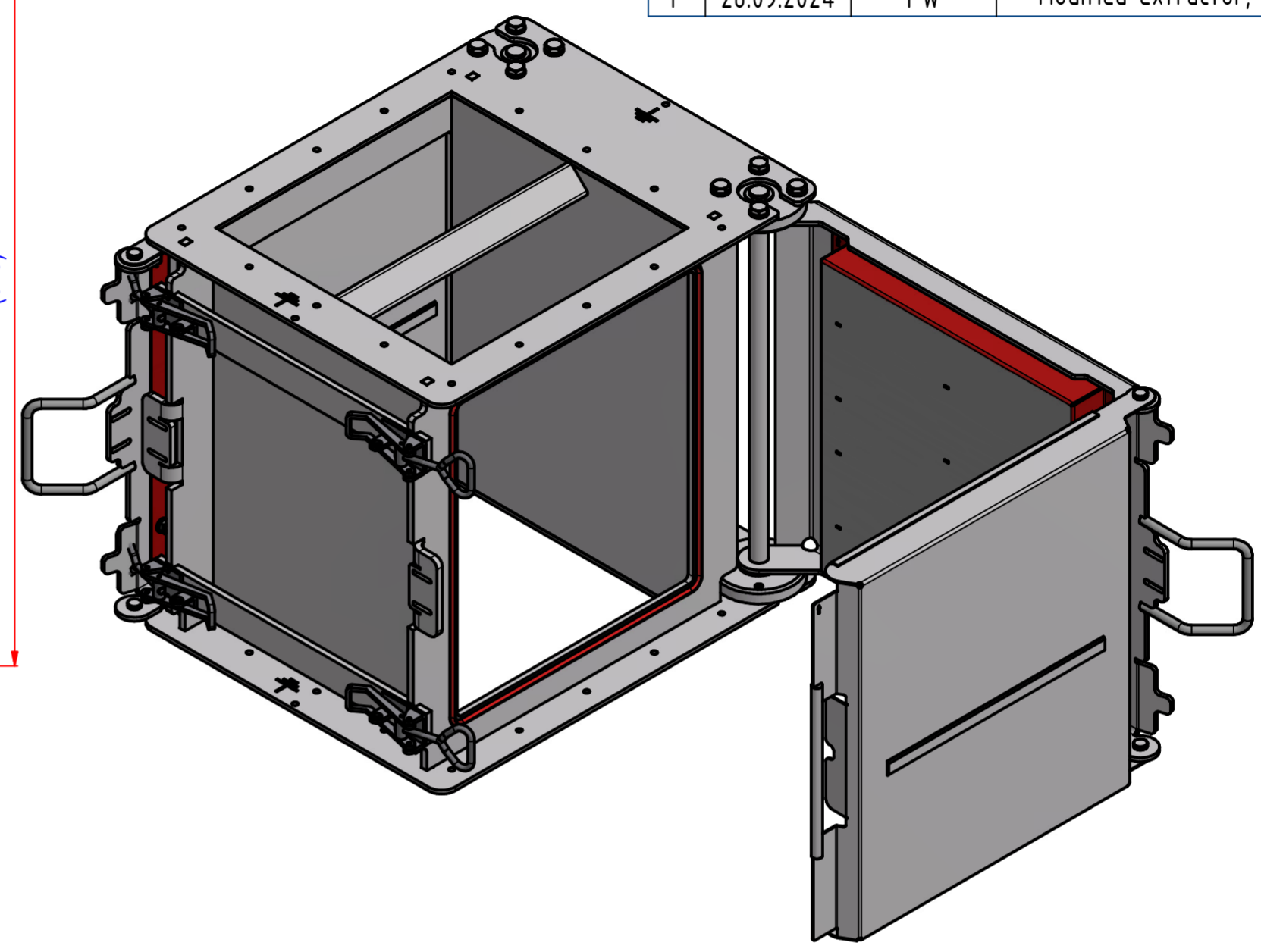

OPTION: SBPN353500 WITH ADAPTER TO DN350

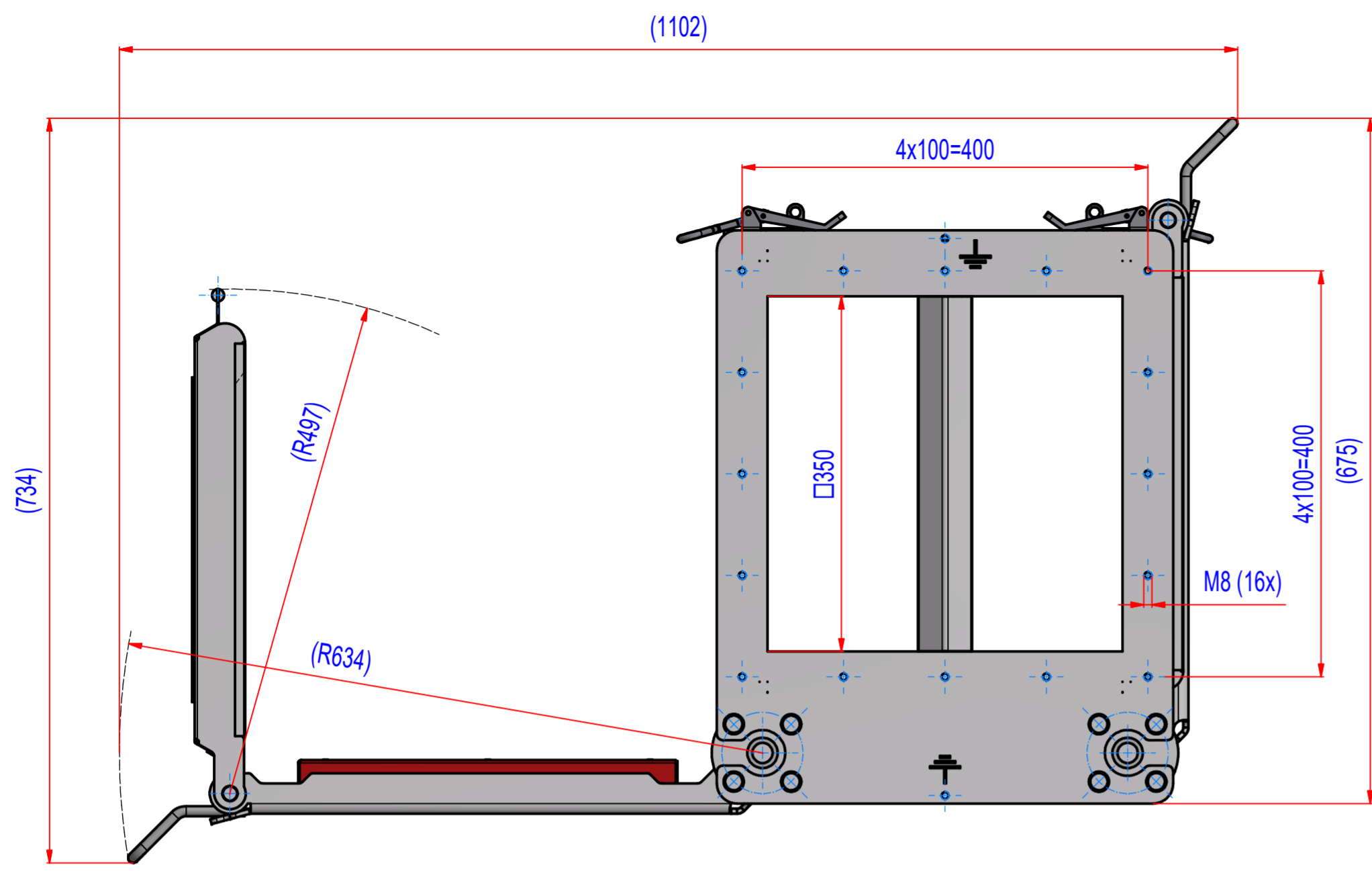
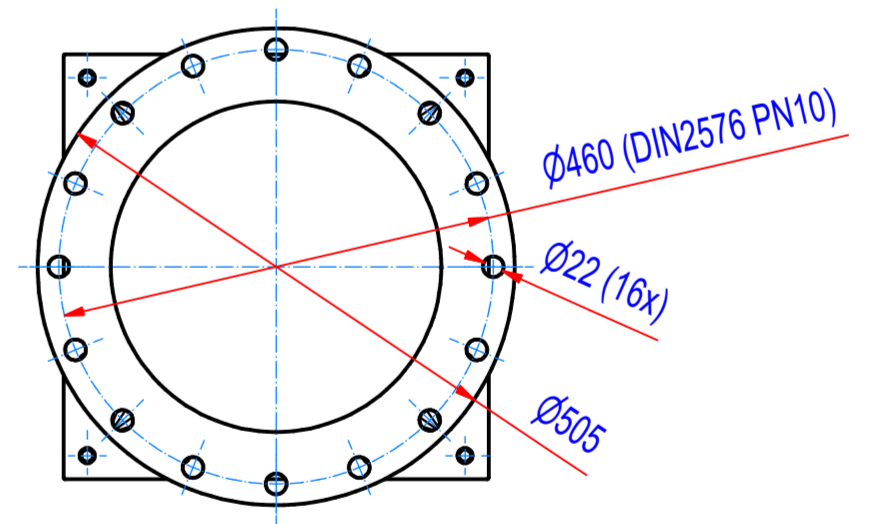
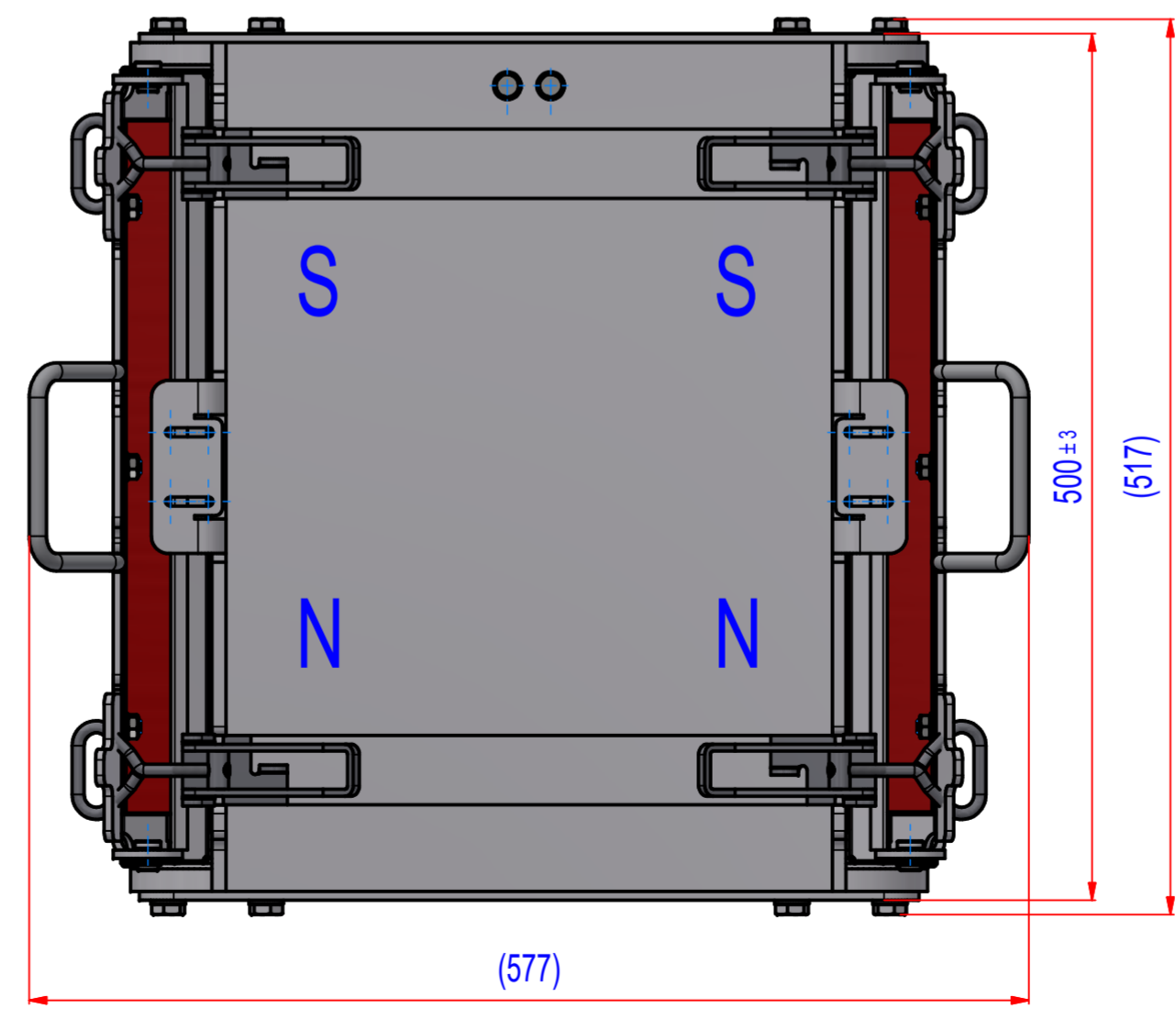
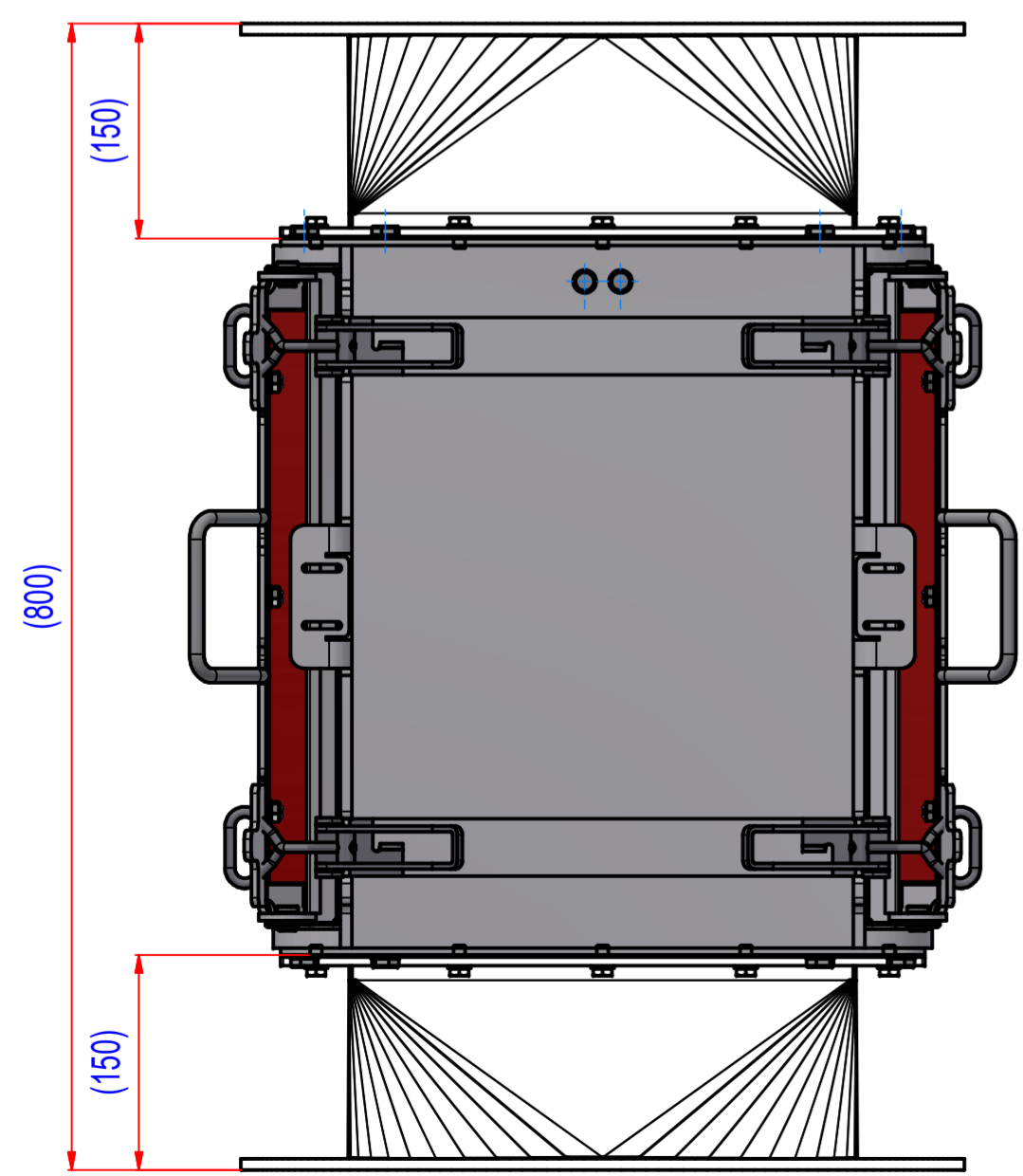

1	A513_000000	SBPN353500	151
POZ./POS.	Č. SOUČÁSTI/ PART NUMBER	POPIS / DESCRIPTION	HMOT./ WEIGHT
APPROVAL PLEASE			
Date:	Order ref.:	Responsible person:	
Sheet: A2	Extra info:	General tolerance: ISO 2768 - cL	
Drawn: PW	Weight (kg): 151	Drawn according: ISO268; ISO1101; ISO2553	
Date: 26.09.2024	GOUDSMIT MAGNETICS	Status:	
Predecessor:		Customer reference number:	
Quick search: XSBP 350	© All rights reserved. Reproduction is not permitted without written permission of GOUDSMIT Magnetic Systems BV		Product key: SBP-3535-N-F1E-B-B
Description: External pole magnet with square connection			Part number: SBPN353500