

REV	DATE	BY	DESCRIPTION
-	19-3-2019	RO	REFERENCE DRAWING E0015745
A	26-4-2019	RO	TOP CHANGED: E0019381 WAS E0013258

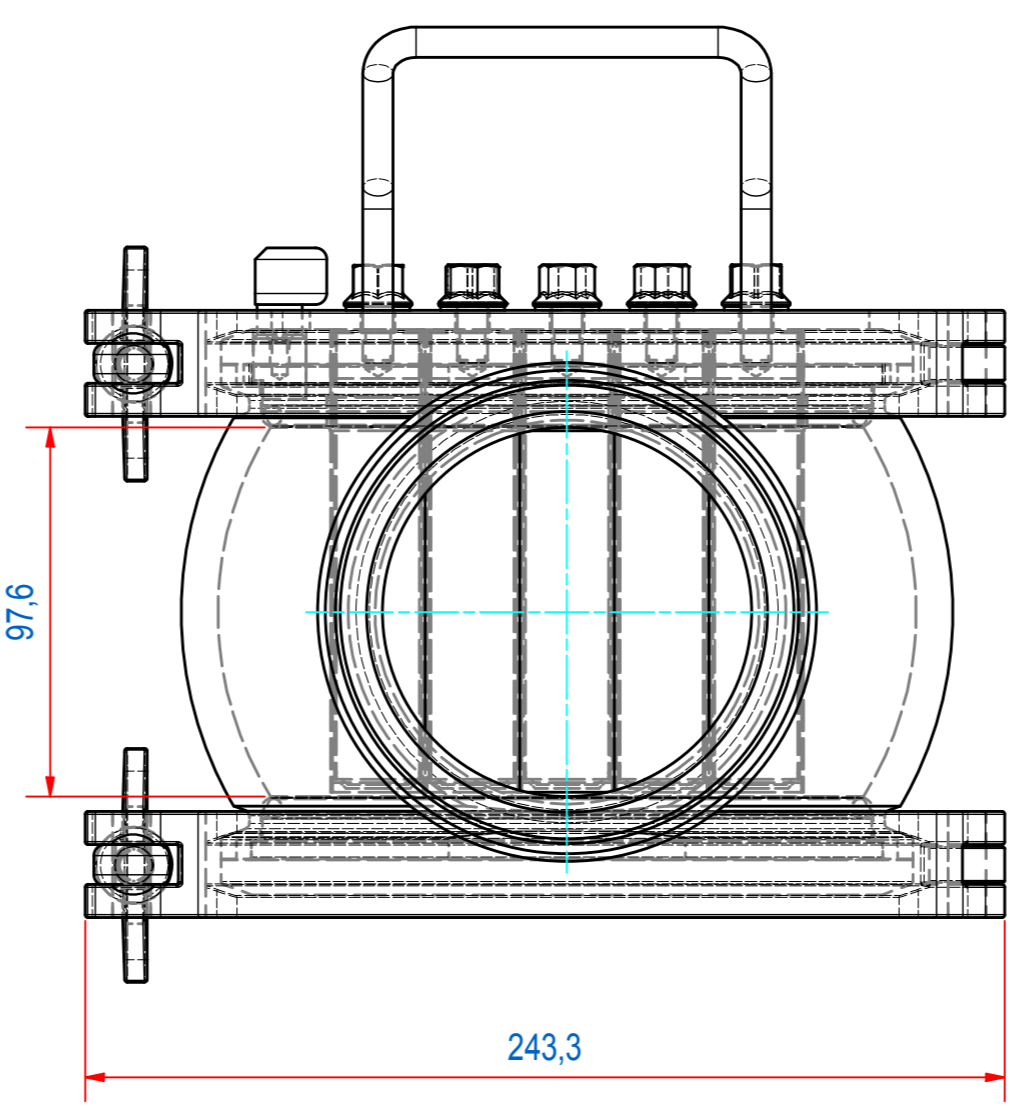
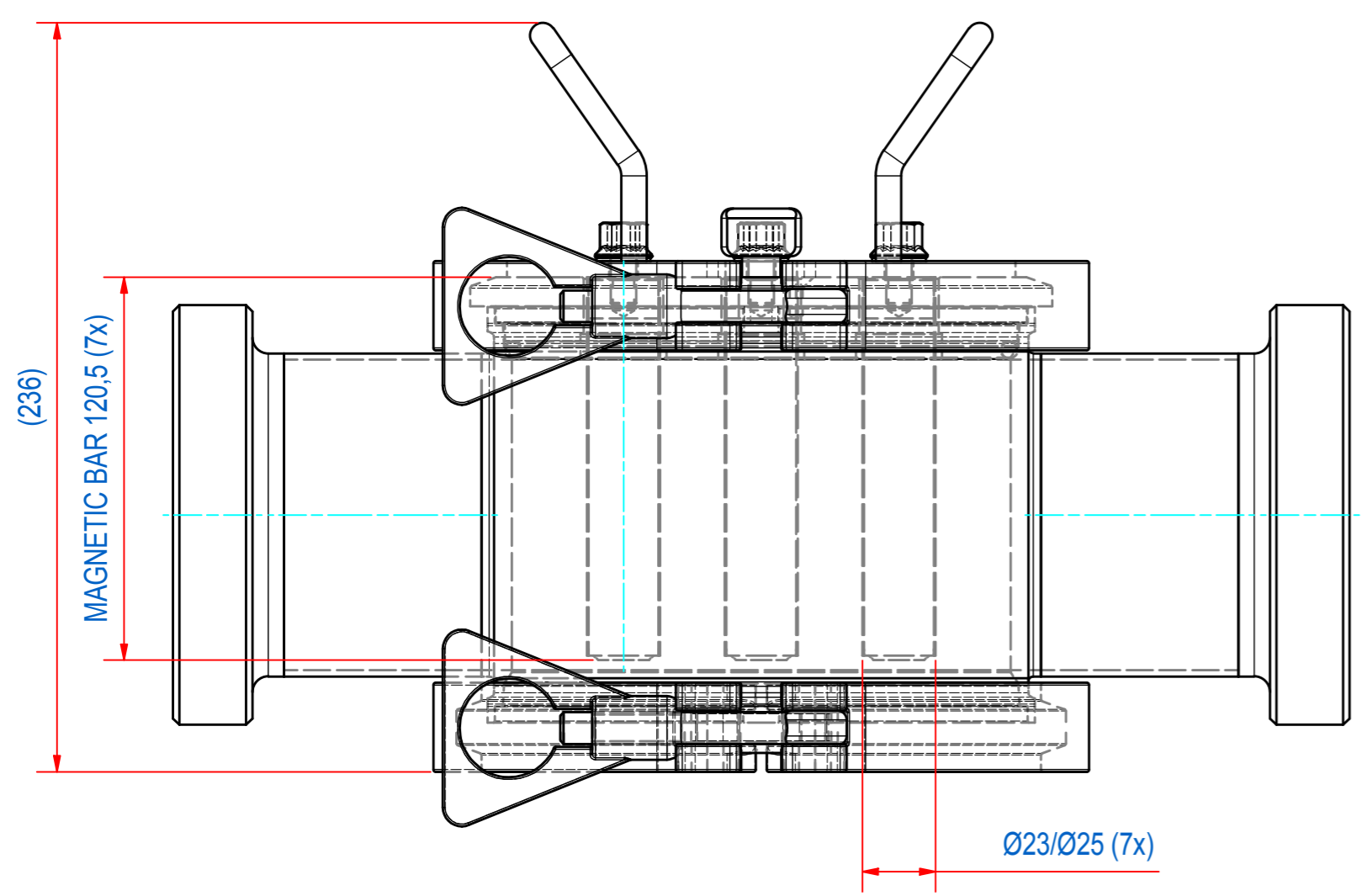
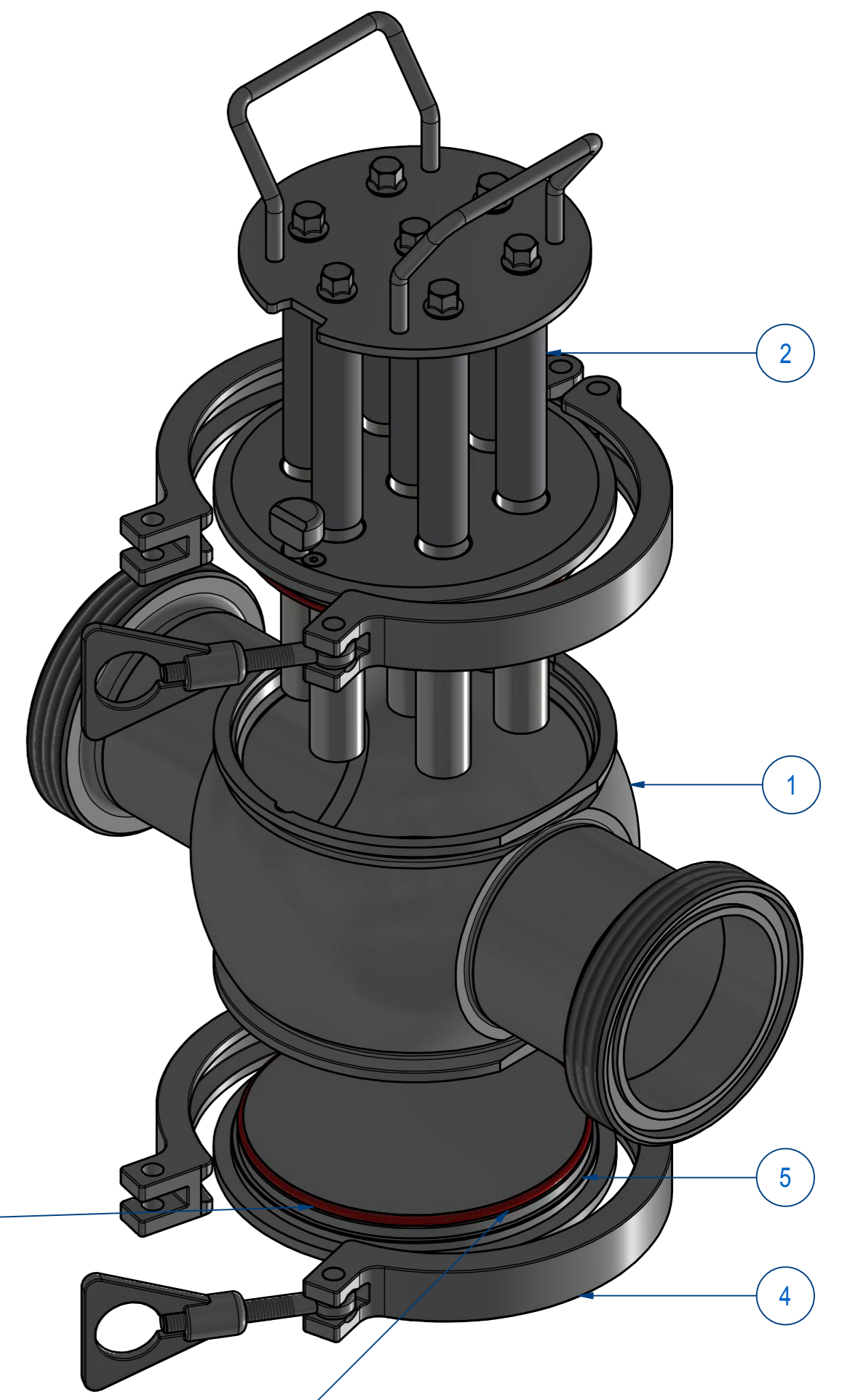
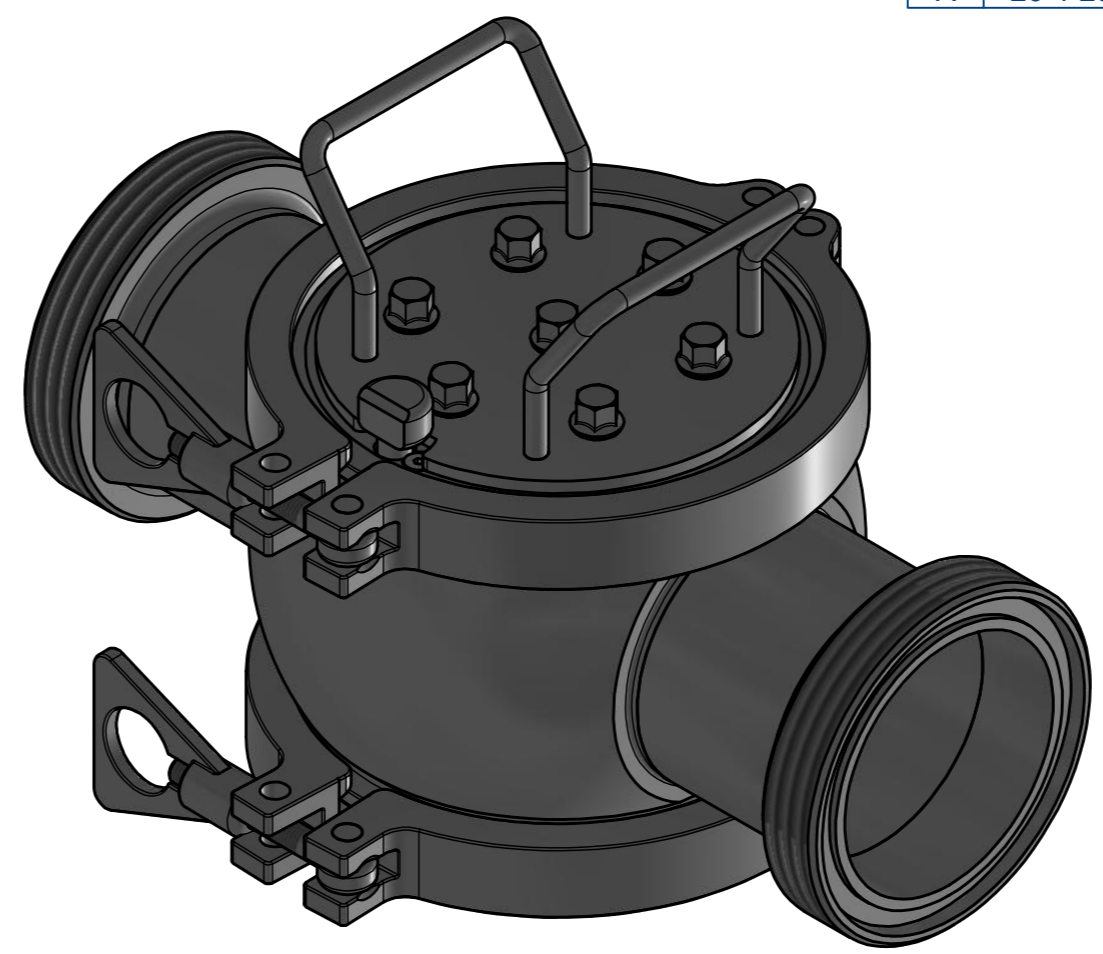
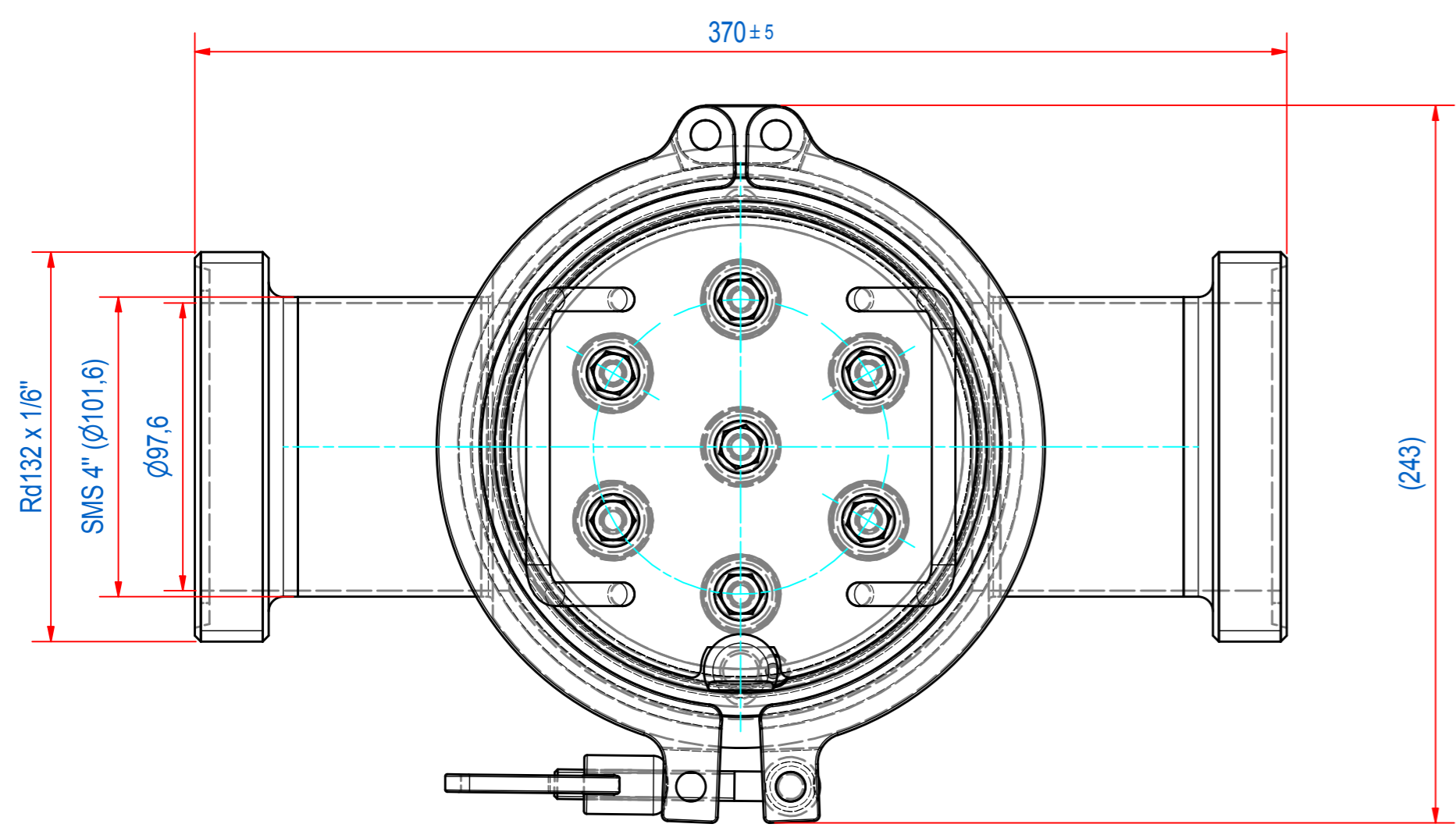

SEAL CONFORM TO HYGIENIC DESIGN

ITEM	QTY	PART NUMBER	DESCRIPTION	Dimensions
5	1	E0016733	SFH-000 BOTTOM PLATE 316L	
4	2	77.9630140	TRI-CLAMP DIN/ISO DN150 Ø183	
3	2	E0018393	O-RING Ø142,24xØ5,33 EC1935	
2	1	E0019381	TOP SFH-4"-7E-HT	
1	1	E0111342	SFH-4" SMS 4" HOUSE 316L	

RAW MAT.	Quantity: 1	Material Number:	Material Description:	Length (mm):	Width (mm):
Sheet:	A2	Extra info:	General tolerance:	ISO 2768 - mK	
Drawn:	RO	Weight (kg): 23,5	Drawn according:	ISO268; ISO1101; ISO2553	
Date:	26-4-2019	Source:	Status:	Released	
Spare part:	False	Quick search:	Customer reference number:		
Description:			Document number:	Doc.Rev:	
SFHZ-4"-ST-07E-HT-F5M-S-B-B			E0111343	A	
			Part number:	Rev:	
			E0111344	A	

GOUDSMIT
MAGNETIC SYSTEMS

© All rights reserved. Reproduction is not permitted without written permission of GOUDSMIT Magnetic Systems BV