

DOC.NR.	REV	DATE	BY	DESCRIPTION
E0136796	-			ORIGINAL DRAWING

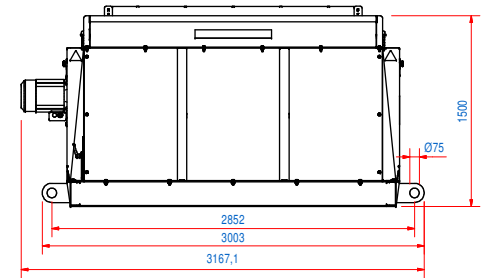

LAYOUT MOUNTING HOLES

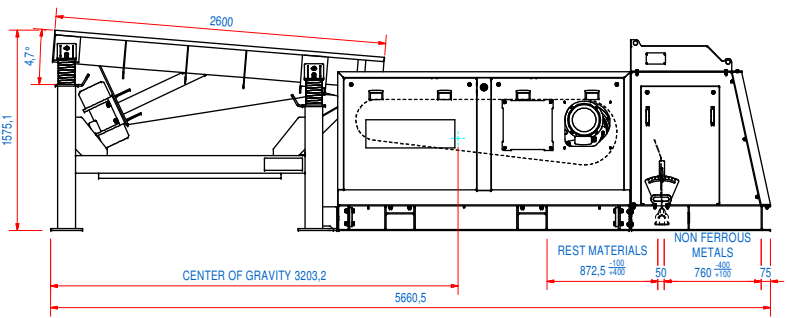
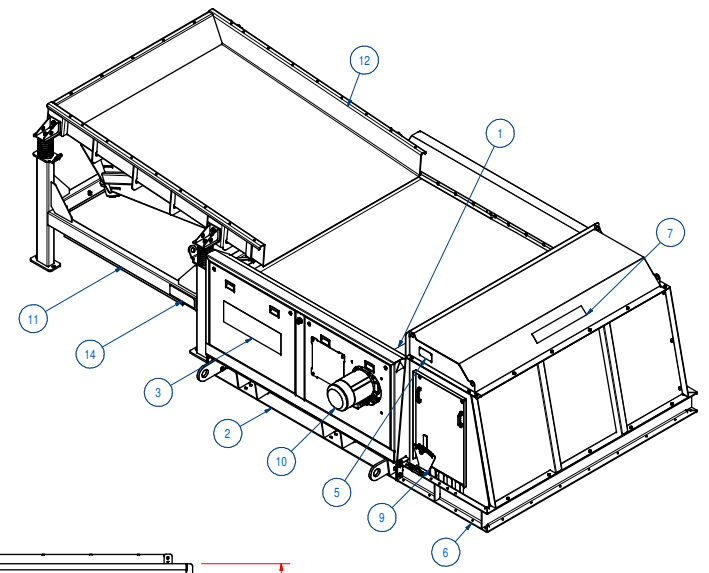
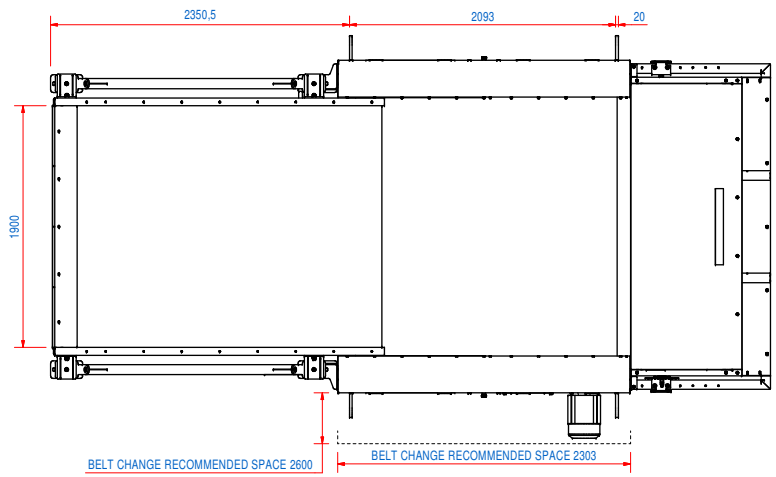
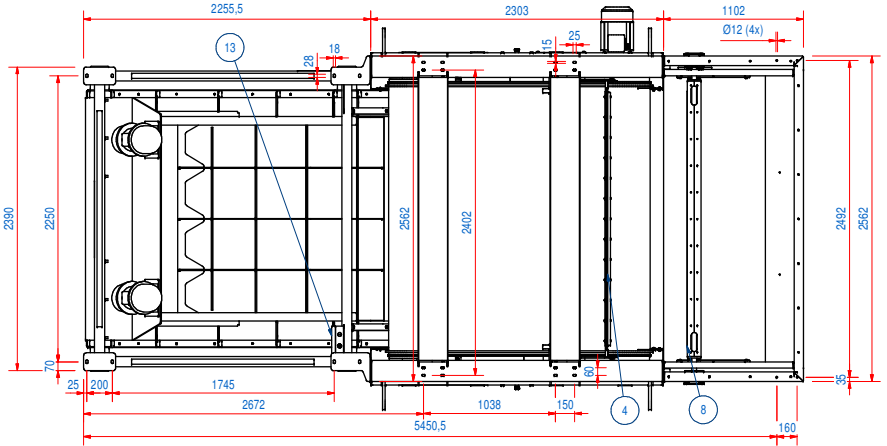

LAYOUT MOUNTING HOLES FUNNEL

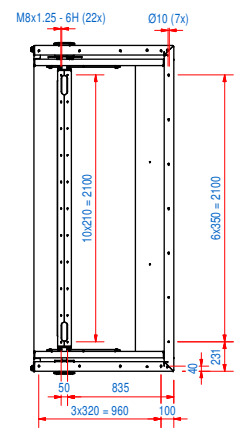

RECOMMENDED FREE SPACE AROUND THE MACHINE FOR INSPECTION IS 800 MM

ITEM	QTY	PART NUMBER	DESCRIPTION	Dimensions
1	1	E0134050	RECV-CS-G-N	
2	1	E0117504	RECV-VB-20-VM26-05-N	
3	1	E0117508	RECV-VF-20-N	
4	1	E0118419	RECM-20-E22HI	
5	2	E0129382	STICKER ECS HOISTING	
6	1	E0075434	RECE-SA-M-B	
7	1	E0118256	RECE-SP-20-S	
8	2	E0120519	STICKER GOUDSMIT MAG. W600 WHITE	
9	1	E0118229	RECE-SB-20-M-ST	
10	1	E0098479	DATA PLATE	
11	1	E0118221	RECE-BS-20-X-NBR	
12	2	E0120504	STICKER EDDYXPERT W700 H222 WHITE	
13	1	E0117564	RECE-EF-20-X-R	
14	1	45.1800049	RECE-CB-20-X-PU-30	

RAW MAT.	Quantity	Material Number	Material Description	Length (mm)	Width (mm)
Sheet	A1	WEBSITE MODEL			
Drawn	IT	3645			
Date:					
Spare part:	False	Source:	MC-C		
Check search:					
Description:	REC-20				

Electrical Properties
CURRENT: 32 A
POWER: 17,5 KVA

General Tolerance: ISO 2768- mK
Drawn according: ISO268, ISO1101, ISO2553
Status: Work in Progress
Customer reference number:
Document number: E0136796
Part number: E0136796