

RECOMMENDED FREE SPACE AROUND THE MACHINE FOR INSPECTION IS 800 MM

LAYOUT MOUNTING HOLES

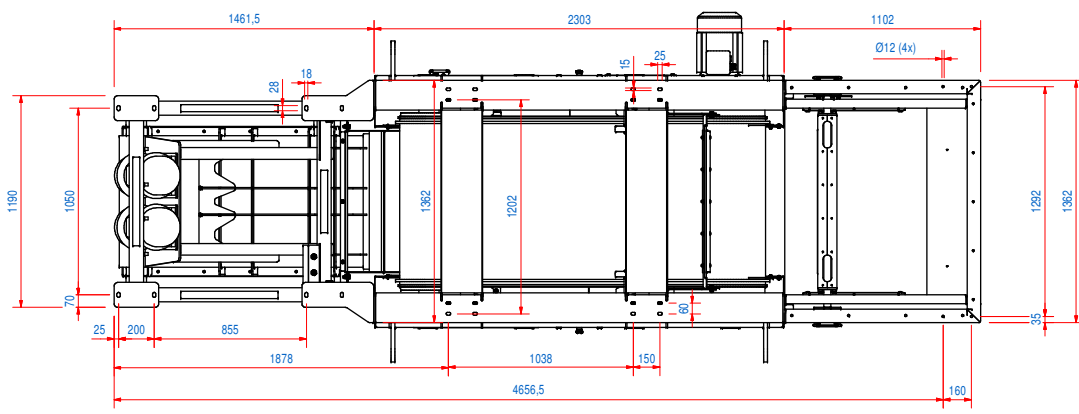

LAYOUT MOUNTING HOLES FUNNEL

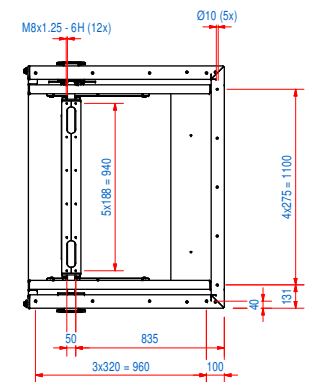

ITEM	QTY	PART NUMBER	DESCRIPTION	Dimensions
18	1	E0109733	RECV-DM-055-F36	
17	2	E0123382	STICKER ECS HOISTING	
16	1	E0122652	RECV-DS-08-S3	
15	1	E0010856	RMD-08-32-RN-B-OR-30S2	
14	1	E0122616	RECV-DH-08-M	
13	1	E0122479	RECV-VB-08-VM16-05-N	
12	1	E0122589	RECV-VF-08-MD	
11	2	E0120504	STICKER EDDYKPERT W700 H222 WHITE	
10	1	E0133469	RECV-CS-G-D	
9	1	E0123213	RECM-08-E22H1	
8	1	E0123218	RECE-BS-08-X-NBR	
7	1	E0122727	RECE-EF-08-X-R	
6	1	E0075434	RECE-SA-M-B	
5	1	E0123399	RECE-SP-08-S	
4	2	E0120519	STICKER GOUDSMIT MAG. W600 WHITE	
3	1	E0123226	RECE-SB-08-M-ST	
2	1	E0098479	DATA PLATE	
1	1	E0122670	RECE-CB-08-X-PU-30	

RAW MAT.	Quantity	Material Number	Material Description	Length (mm)	Width (mm)
1	1				
Sheet: A1 Drawn according to: WEBSITE MODEL Date: 22-10-2020 Spare part: F36S Source: MC-C Quick search: REC-08				General tolerance: ISO 2768- mK Drawn according to: ISO268, ISO1101, ISO2553 Status: Work in Progress Customer reference number: Document number: E0136862 Part number: E0136862	
Description: REC-08-E22H1-B-MAB-SM-PU-R				Disc. Rev:	

ELECTRICAL PROPERTIES
CURRENT: 25 A
POWER: 15,1 KVA