

## Eddy current separator for non-ferro

REC – 06 – 22HI – F – VB – SM – PU – R – R

Product	
REC	Eddy Current separator for non-ferro
RECZ	Special Eddy Current separator for non-ferro

Effective belt width [dm]

Magnet rotor type <a href="#">(see page 28)</a>	
12P	Eccentric 12 Poles ø300/Ø500mm
22HI	Eccentric 22 High intensity poles ø300/Ø500mm
38HI	Eccentric 38 High intensity poles ø500/Ø700mm
Z...(HI)	Special ... poles

Ferrous pre-separator type (head pulley/drum separator) <a href="#">(see page 9 / 21)</a>	
N	No ferrous pre-separator
F	Drum separator: Ferrite magnet system: axial pole 1800 gauss
B	Drum separator: Basic magnet system: axial pole 3000 gauss
P	Drum separator: Power magnet system: axial pole 6000 gauss
K	Head pulley: High gradient magnet system: radial pole 8000/9000 gauss - HPS170 (excl. overband)
L	Head pulley: High gradient magnet system: radial pole 8000/9000 gauss - HPS170 (incl. overband)
H	Head pulley: High gradient magnet system: radial pole 8000/9000 gauss – HPS300 (excl. overband)
Z	Special ferrous separator

Feeder unit <a href="#">(see page 14 / 15 / 16 / 17)</a>			
N	No feeder unit	VM	Vibration unit L 1600/ 2000/2600 mm / 5° / Lining add. Mn steel plate
VB	Vibration unit L 1600/2000/2600 mm / 5° / Basic (Mn steel), no lining	CS	Conveyor feeder Standard length L=2000 mm
VP	Vibration unit L 1600/2000/2600 mm / 5° / Lining Diamond PU coating	Z	Special feeder unit

**Info:** L: 1600 mm (for NF600-800) – 2000 mm (for NF1000-1500) – 2600 mm (for NF2000)

Separation unit <a href="#">(see page 7 / 19 / 30)</a>			
N	No separation unit	FTM	Fines fraction Trespa separation plate, Manually operated
CM	Coarse fraction separation plate, Manually operated	FMM	Fines fraction Mn steel separation plate, Manually operated
CS	Coarse fraction separation plate, Spindle operated	FTS	Fines fraction Trespa separation plate, Spindle operated
SM	Standard (medium fraction), Mn steel sep. plate, Manually oper.	FMS	Fines fraction Mn steel separation plate, Spindle operated
SS	Standard (medium fraction), Mn steel sep. plate, Spindle oper.	Z	Special separation unit

Eddy current belt type <a href="#">(see page 24)</a>			
N	No belt	PVC	PVC belt
NBR	Rubber belt	Z	Special Belt
PU	PU belt		

Eddy current belt scraper <a href="#">(see page 29)</a>			
N	No scraper	S	Scraper with Steel tip
R	Scraper with Rubber tip	Z	Special scraper
P	Scraper with PU tip		

Belt exchange side	
R	Right (standard)
L	Left

## Eddy current separator for non-ferro – Machine configuration

Machine:

Unit:

Module:

<b>REC</b>	<b>Eddy Current separator for non-ferro</b>																								
		<b>Conveyor feeder</b>	<table border="1"> <tr><td><a href="#">REC-CU</a></td><td>Conveyor feeder Unit</td></tr> <tr><td><a href="#">REC-CB</a></td><td>Conveyor feeder Belt</td></tr> <tr><td><a href="#">REC-CC</a></td><td>Conveyor feeder Cover</td></tr> <tr><td><a href="#">REC-CF</a></td><td>Conveyor feeder Frame</td></tr> <tr><td><a href="#">REC-CS</a></td><td>Conveyor feeder Separation plate</td></tr> <tr><td><a href="#">REC-CO</a></td><td>Conveyor feeder Outer belt Scraper</td></tr> <tr><td><a href="#">RHP</a></td><td>Magnetic Head Pulley</td></tr> <tr><td><a href="#">REC-MM</a></td><td>Magnetic head pulley Motor</td></tr> <tr><td><a href="#">REC-CE</a></td><td>Conveyor feeder Electr connection</td></tr> <tr><td><a href="#">REC-CL</a></td><td>Conveyor feeder central Lubrication points</td></tr> <tr><td><a href="#">REC-OF</a></td><td>Overband magnet with Frame</td></tr> </table>	<a href="#">REC-CU</a>	Conveyor feeder Unit	<a href="#">REC-CB</a>	Conveyor feeder Belt	<a href="#">REC-CC</a>	Conveyor feeder Cover	<a href="#">REC-CF</a>	Conveyor feeder Frame	<a href="#">REC-CS</a>	Conveyor feeder Separation plate	<a href="#">REC-CO</a>	Conveyor feeder Outer belt Scraper	<a href="#">RHP</a>	Magnetic Head Pulley	<a href="#">REC-MM</a>	Magnetic head pulley Motor	<a href="#">REC-CE</a>	Conveyor feeder Electr connection	<a href="#">REC-CL</a>	Conveyor feeder central Lubrication points	<a href="#">REC-OF</a>	Overband magnet with Frame
<a href="#">REC-CU</a>	Conveyor feeder Unit																								
<a href="#">REC-CB</a>	Conveyor feeder Belt																								
<a href="#">REC-CC</a>	Conveyor feeder Cover																								
<a href="#">REC-CF</a>	Conveyor feeder Frame																								
<a href="#">REC-CS</a>	Conveyor feeder Separation plate																								
<a href="#">REC-CO</a>	Conveyor feeder Outer belt Scraper																								
<a href="#">RHP</a>	Magnetic Head Pulley																								
<a href="#">REC-MM</a>	Magnetic head pulley Motor																								
<a href="#">REC-CE</a>	Conveyor feeder Electr connection																								
<a href="#">REC-CL</a>	Conveyor feeder central Lubrication points																								
<a href="#">REC-OF</a>	Overband magnet with Frame																								
		Or/and																							
		<b>Vibration feeder</b>	<table border="1"> <tr><td><a href="#">REC-VF</a></td><td>Vibration feeder Frame</td></tr> <tr><td><a href="#">REC-VB</a></td><td>Vibration feeder Bin</td></tr> <tr><td><a href="#">REC-VC</a></td><td>Vibration feeder Cover</td></tr> <tr><td><a href="#">REC-VW</a></td><td>Vibration feeder Wear plate</td></tr> <tr><td><a href="#">REC-DH</a></td><td>Drum Housing</td></tr> <tr><td><a href="#">REC-DS</a></td><td>Drum Separation plate</td></tr> <tr><td><a href="#">REC-DC</a></td><td>Drum housing Cover</td></tr> <tr><td><a href="#">RMD</a></td><td>Magnetic Drum separator</td></tr> <tr><td><a href="#">REC-DM</a></td><td>Drum Motor</td></tr> <tr><td><a href="#">REC-VE</a></td><td>Vibration feeder Electr connection</td></tr> </table>	<a href="#">REC-VF</a>	Vibration feeder Frame	<a href="#">REC-VB</a>	Vibration feeder Bin	<a href="#">REC-VC</a>	Vibration feeder Cover	<a href="#">REC-VW</a>	Vibration feeder Wear plate	<a href="#">REC-DH</a>	Drum Housing	<a href="#">REC-DS</a>	Drum Separation plate	<a href="#">REC-DC</a>	Drum housing Cover	<a href="#">RMD</a>	Magnetic Drum separator	<a href="#">REC-DM</a>	Drum Motor	<a href="#">REC-VE</a>	Vibration feeder Electr connection		
<a href="#">REC-VF</a>	Vibration feeder Frame																								
<a href="#">REC-VB</a>	Vibration feeder Bin																								
<a href="#">REC-VC</a>	Vibration feeder Cover																								
<a href="#">REC-VW</a>	Vibration feeder Wear plate																								
<a href="#">REC-DH</a>	Drum Housing																								
<a href="#">REC-DS</a>	Drum Separation plate																								
<a href="#">REC-DC</a>	Drum housing Cover																								
<a href="#">RMD</a>	Magnetic Drum separator																								
<a href="#">REC-DM</a>	Drum Motor																								
<a href="#">REC-VE</a>	Vibration feeder Electr connection																								
		<b>Eddy current unit</b>	<table border="1"> <tr><td><a href="#">REC-EB</a></td><td>EC unit Belt</td></tr> <tr><td><a href="#">REC-EF</a></td><td>EC unit Frame</td></tr> <tr><td><a href="#">REC-EE</a></td><td>EC unit Electrical connection</td></tr> <tr><td><a href="#">REC-EC</a></td><td>EC unit Cover</td></tr> <tr><td><a href="#">REC-MR</a></td><td>EC Magnet Roller</td></tr> <tr><td><a href="#">REC-ES</a></td><td>EC belt Scraper</td></tr> <tr><td><a href="#">REC-SP</a></td><td>Separation Plate</td></tr> <tr><td><a href="#">REC-SA</a></td><td>Separation plate Angle adjustment</td></tr> <tr><td><a href="#">REC-SB</a></td><td>Separation Box</td></tr> </table>	<a href="#">REC-EB</a>	EC unit Belt	<a href="#">REC-EF</a>	EC unit Frame	<a href="#">REC-EE</a>	EC unit Electrical connection	<a href="#">REC-EC</a>	EC unit Cover	<a href="#">REC-MR</a>	EC Magnet Roller	<a href="#">REC-ES</a>	EC belt Scraper	<a href="#">REC-SP</a>	Separation Plate	<a href="#">REC-SA</a>	Separation plate Angle adjustment	<a href="#">REC-SB</a>	Separation Box				
<a href="#">REC-EB</a>	EC unit Belt																								
<a href="#">REC-EF</a>	EC unit Frame																								
<a href="#">REC-EE</a>	EC unit Electrical connection																								
<a href="#">REC-EC</a>	EC unit Cover																								
<a href="#">REC-MR</a>	EC Magnet Roller																								
<a href="#">REC-ES</a>	EC belt Scraper																								
<a href="#">REC-SP</a>	Separation Plate																								
<a href="#">REC-SA</a>	Separation plate Angle adjustment																								
<a href="#">REC-SB</a>	Separation Box																								
		<b>Control box</b>	<table border="1"> <tr><td><a href="#">REC-E-CB</a></td><td>Control Box</td></tr> <tr><td><a href="#">REC-E-CS</a></td><td>Cable Set</td></tr> </table>	<a href="#">REC-E-CB</a>	Control Box	<a href="#">REC-E-CS</a>	Cable Set																		
<a href="#">REC-E-CB</a>	Control Box																								
<a href="#">REC-E-CS</a>	Cable Set																								

## Eddy current separator – Conveyor feeder unit

REC-CU – 08 – B – 20 – L

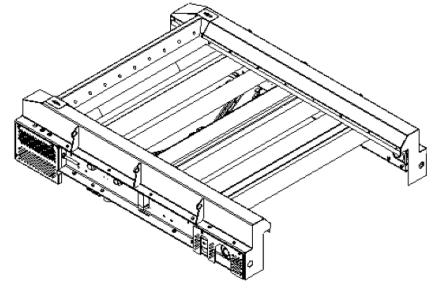

Module	
REC-CU	Conveyor feeder Unit
RECZ-CU	Special Conveyor feeder Unit

Applicable for working width [dm]	
06	For belt width 600 mm
08	For belt width 800 mm
10	For belt width 1000 mm
15	For belt width 1500 mm
20	For belt width 2000 mm

Type	
B	Basic (1800 / 3000 gauss)
H170	High gradient HPS170 (9000 gauss)
H300	High gradient HPS300 (9000 gauss)
Z	Special

Conveyor feeder length [dm]	
20	Conveyor feeder, length 2000 mm (standard)
Z	Special conveyor feeder length

Belt exchange side	
L	Left (seen in transport direction)
R	Right (seen in transport direction)

## Eddy current separator – Conveyor feeder belt

REC-CB – 08 – C20 – NBR – 50 – NC

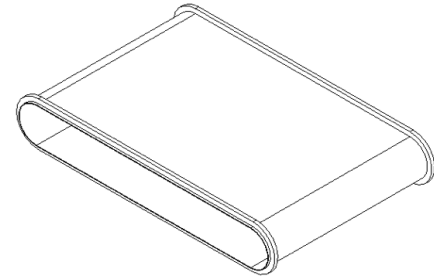

Module	
REC-CB	Conveyor feeder Belt
RECZ-CB	Special Conveyor feeder Belt

Applicable for working width [dm]	
06	For belt width 600 mm
08	For belt width 800 mm
10	For belt width 1000 mm
15	For belt width 1500 mm
20	For belt width 2000 mm

Material feeder length	
C170	Conveyor feeder for HPS170
C300	Conveyor feeder for HPS300
Z	Special conveyor feeder length

Conveyor belt material	
NBR	Rubber
PVC	PVC
PU	Polyurethane
Z	Special conveyor belt material

Belt thickness	
13	1.3 mm
50	5.0 mm
Z	Special belt thickness

Belt type	
NC	No Cleats (Standard for NBR)
1C	1 Cleat
2C	2 Cleats (Standard for PU)

## Eddy current separator – Conveyor feeder cover

REC-CC – 08 – C20 – D250

Module	
REC-CC	Conveyor feeder Cover
RECZ-CC	Special Conveyor feeder Cover

Applicable for working width [dm]	
06	For belt width 600 mm
08	For belt width 800 mm
10	For belt width 1000 mm
15	For belt width 1500 mm
20	For belt width 2000 mm

Conveyor feeder length	
C20	Conveyor feeder, length 2000 mm
Z	Special conveyor feeder length

Suction flange connection size	
N	No suction flange, closed dust cover
D150	Diameter 150 mm
D250	Diameter 250 mm
Z	Special suction point

## Eddy current separator – Conveyor feeder frame

REC-CF – 08 – B – 20 – S

Module	
REC-CF	Conveyor feeder Frame
RECZ-CF	Special Conveyor feeder Frame

Applicable for working width [dm]	
06	For belt width 600 mm
08	For belt width 800 mm
10	For belt width 1000 mm
15	For belt width 1500 mm
20	For belt width 2000 mm

Type	
B	Basic (1800 / 3000 gauss)
H170	High gradient HPS170 (9000 gauss)
H300	High gradient HPS300 (9000 gauss)
Z	Special

Conveyor feeder length [dm]	
20	Conveyor feeder, length 2000 mm (standard)
Z	Special conveyor feeder length

Conveyor feeder frame covering	
S	Solid plate covering
M	Mesh plate covering
Z	Special conveyor feeder frame covering

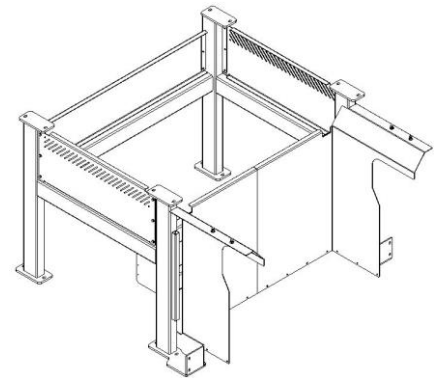

## Eddy current separator – Conveyor feeder separation plate

REC-CS – 08 – SS

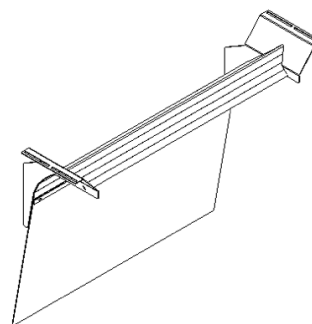

Module	
REC-CS	Conveyor feeder Separation plate
RECZ-CS	Special Conveyor feeder Separation plate

Applicable for working width [dm]	
06	For belt width 600 mm
08	For belt width 800 mm
10	For belt width 1000 mm
15	For belt width 1500 mm
20	For belt width 2000 mm

Separation plate material	
SS	Stainless steel
Mn	Manganese steel
Z	Special material

## Eddy current separator – Conveyor feeder outer belt scraper

REC-CO – 08 – ST

Module	
REC-CO	Conveyor feeder Outer belt scraper
RECZ-CO	Special conveyor feeder Outer belt scraper

Applicable for working width [dm]	
06	For belt width 600 mm
08	For belt width 800 mm
10	For belt width 1000 mm
15	For belt width 1500 mm
20	For belt width 2000 mm

Scraper material	
ST	Steel
Z	Special material

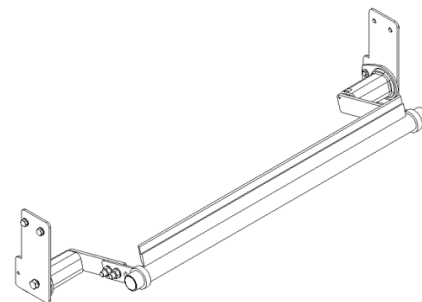



## Magnetic head pulley

RHP - [ ]

Module	
RHP	Magnetic Head Pulley
RHPZ	Special Magnetic Head Pulley

See Magnetic head pulley Product key

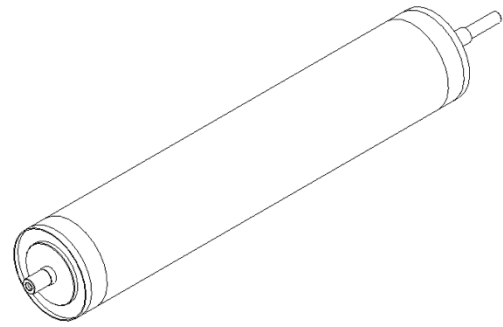

## Eddy current separator – Magnetic head pulley motor

REC-MM – 300 – F84 – L

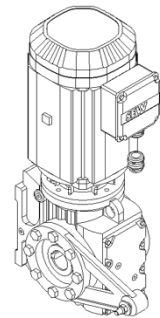

Module	
REC-MM	Magnetic head pulley Motor
RECZ-MM	Special Magnetic head pulley Motor

Power	
300	3,0 kW
...	... kW

Drive type	
F84	Fixed speed 84 rpm
Z	Special drive

Position	
L	Left (seen in transport direction)
R	Right (seen in transport direction)

## Eddy current separator – Conveyor feeder electrical connection

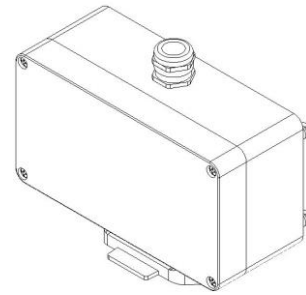
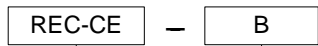

Module	
REC-CE	Conveyor feeder Electrical connection
RECZ-CE	Special Conveyor feeder Electrical connection

Type	
B	Standard (Basic) connector socket
Z	Special connector socket

## Eddy current separator – Conveyor feeder central lubrication points

REC-CL – B – L

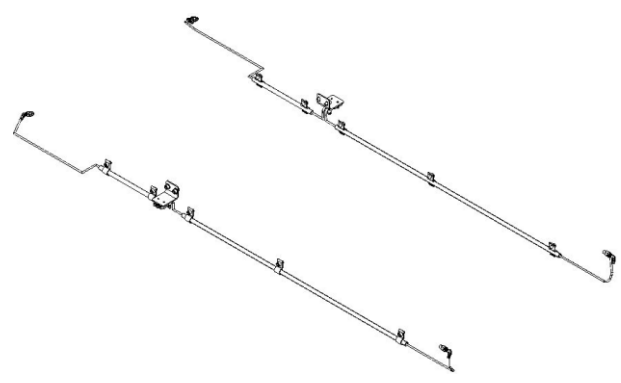

Module	
REC-CL	Conveyor feeder central Lubrication points
RECZ-CL	Special Conveyor feeder central Lubrication points

Type	
B	Standard (Basic) lubrication points
Z	Special lubrication points

Version	
L	Left version
R	Right version

## Eddy current separator – Overband magnet with frame

REC-OF – 15 – F2

Module	
REC-OF	Overband magnet with Frame
RECZ-OF	Special Overband magnet with Frame

Applicable for working width [dm]	
06	For belt width 600 mm
08	For belt width 800 mm
10	For belt width 1000 mm
15	For belt width 1500 mm
20	For belt width 2000 mm

Overband type	
F2	Type F2 overband (ferrite, susp range 250-300mm)

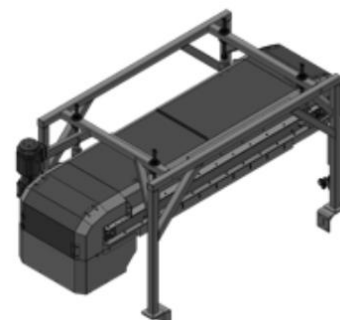

## Eddy current separator – Vibration feeder frame

REC-VF – 08 – ND

Module	
REC-VF	Vibration feeder Frame
RECZ-VF	Special Vibration feeder Frame

Applicable for working width [dm]	
06	For belt width 600 mm
08	For belt width 800 mm
10	For belt width 1000 mm
15	For belt width 1500 mm
20	For belt width 2000 mm

Type	
ND	For No Drum separator
MD	For Medium size Drum housing (opening 85 mm)
LD	For Large size Drum housing (opening 170 mm)
HP	For Head pulley HPS170
Z	Special version

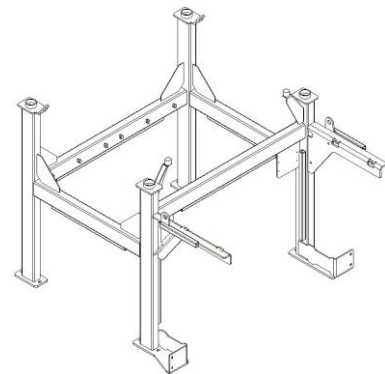

## Eddy current separator – Vibration feeder bin

REC-VB – 08 – VM16 – 05 – N

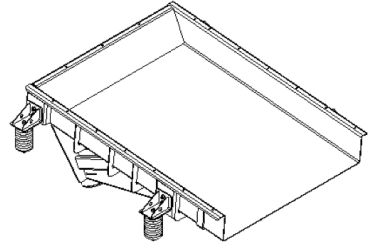

Module	
REC-VB	Vibration feeder Bin
RECZ-VB	Special Vibration feeder Bin

Applicable for working width [dm]	
06	For belt width 600 mm
08	For belt width 800 mm
10	For belt width 1000 mm
15	For belt width 1500 mm
20	For belt width 2000 mm

Feeder length	
VM16	Vibration feeder, 1600 mm (for NF600/800)
VM20	Vibration feeder, 2000 mm (for NF1000/1500)
VM26	Vibration feeder, 2600 mm (for NF2000)
Z	Special feeder length

Angle	
05	5°
Z	Special angle

Wear plate interface	
N	Interface for No wear plate
Mn	Interface for Lining additional Mn steel plate
Z	Special lining material

## Eddy current separator – Vibration feeder cover

REC-VC – 08 – VM16 – D250

Module	
REC-VC	Vibration feeder Cover
RECZ-VC	Special Vibration feeder Cover

Applicable for working width [dm]	
06	For belt width 600 mm
08	For belt width 800 mm
10	For belt width 1000 mm
15	For belt width 1500 mm
20	For belt width 2000 mm

Feeder length	
VM16	Vibration feeder, 1600 mm (for NF600/800)
VM20	Vibration feeder, 2000 mm (for NF1000/1500)
VM26	Vibration feeder, 2600 mm (for NF2000)
Z	Special feeder length

Suction flange connection size	
N	No suction flange, closed dust cover
D150	Diameter 150 mm
D250	Diameter 250 mm
Z	Special suction point



## Eddy current separator – Vibration feeder wear plate

REC-VW – 08 – VM16 – Mn

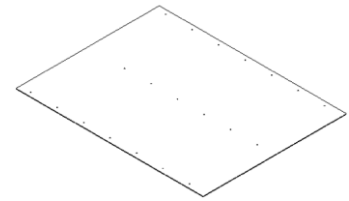

Module	
REC-VW	Vibration feeder Wear Plate
RECZ-VW	Special vibration feeder Wear Plate

Applicable for working width [dm]	
06	For belt width 600 mm
08	For belt width 800 mm
10	For belt width 1000 mm
15	For belt width 1500 mm
20	For belt width 2000 mm

Feeder length	
VM16	Vibration feeder, 1600 mm (for NF600/800)
VM20	Vibration feeder, 2000 mm (for NF1000/1500)
VM26	Vibration feeder, 2600 mm (for NF2000)
Z	Special feeder length

Wear plate material	
B2	Breaker bars (2x) directly to bin
PU	Lining diamond PU coating
Mn	Lining additional Mn steel plate
Z	Special lining material

## Eddy current separator – Vibration feeder drum housing

REC-DH – 08 – MD

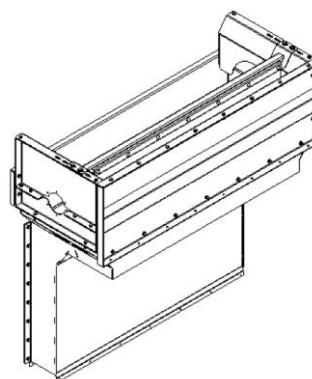

Module	
REC-DH	Vibration feeder Drum Housing
RECZ-DH	Special vibration feeder Drum Housing

Applicable for working width [dm]	
06	For belt width 600 mm
08	For belt width 800 mm
10	For belt width 1000 mm
15	For belt width 1500 mm
20	For belt width 2000 mm

Drum housing size	
MD	Medium housing (for particle size < 85 mm)
LD	Large housing (for particle size < 170 mm)
Z	Special housing size

## Eddy current separator – Magnetic drum separation plate

REC-DS – 08 – SS

Module	
REC-DS	Magnetic Drum Separation plate
RECZ-DS	Special magnetic Drum Separation plate

Applicable for working width [dm]	
06	For belt width 600 mm
08	For belt width 800 mm
10	For belt width 1000 mm
15	For belt width 1500 mm
20	For belt width 2000 mm

Separation plate material	
SS	Stainless steel
Mn	Manganese steel
Z	Special material

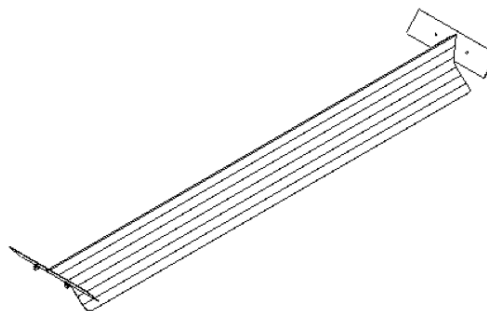

## Eddy current separator – Magnetic drum housing cover

REC-DC – 08 – M – D250

Module	
REC-DC	Magnetic Drum housing Cover
RECZ-DC	Special magnetic Drum housing Cover

Applicable for working width [dm]	
06	For belt width 600 mm
08	For belt width 800 mm
10	For belt width 1000 mm
15	For belt width 1500 mm
20	For belt width 2000 mm

Drum housing size	
M	Medium housing (for particle size < 85 mm)
L	Large housing (for particle size < 170 mm)
Z	Special housing size

Suction flange connection size	
N	No suction flange, closed dust cover
D150	Diameter 150 mm
D250	Diameter 250 mm
Z	Special suction point

## Magnetic drum separator

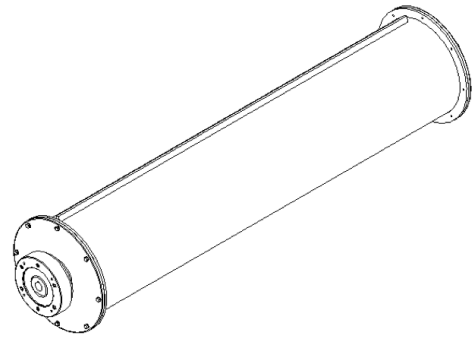
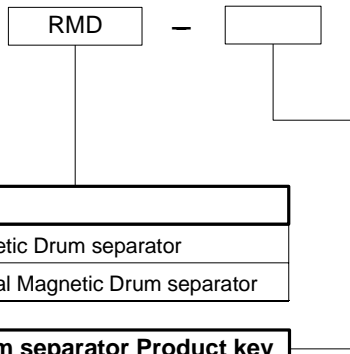

## Eddy current separator – Magnetic drum motor

REC-DM – 055 – F36

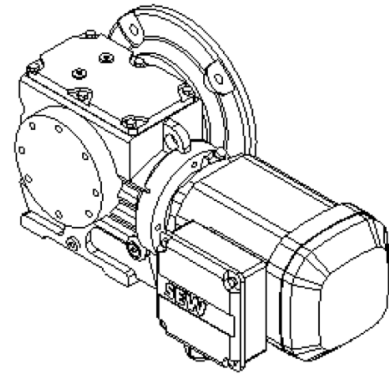

Module	
REC-DM	Magnetic Drum Motor
RECZ-DM	Special magnetic Drum Motor

Power	
055	0,55 kW
110	1,1 kW
...	... kW

Drive type	
F36	Fixed speed 36 rpm
F37	Fixed speed 37 rpm
F..	Fixed speed ... rpm
V53	Variable speed 5,3 - 53 rpm
V..	Variable speed ... - ... rpm
Z	Special drive

## Eddy current separator – Vibration feeder electrical connection

REC-VE – G – N

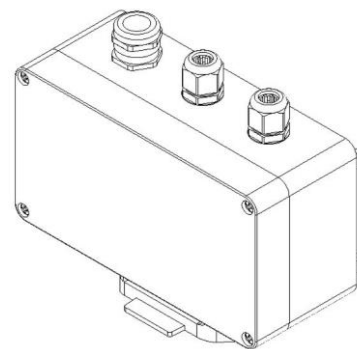

Module	
REC-VE	Vibration feeder Electrical connection
RECZ-VE	Special Vibration feeder Electrical connection

Connection	
G	cable Gland
C	Connector

Type	
N	No drum separator
D	Drum separator
Z	Special connector socket

## Eddy current separator – Eddy current unit belt

REC-EB – 08 – X – NBR – 60

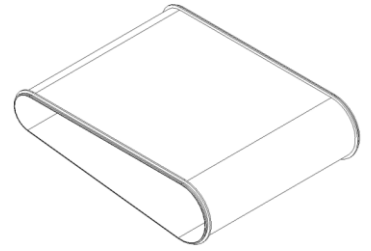

Module	
REC-EB	Eddy current unit Belt
RECZ-EB	Special Eddy current unit Belt

Applicable for working width [dm]	
06	For belt width 600 mm
08	For belt width 800 mm
10	For belt width 1000 mm
15	For belt width 1500 mm
20	For belt width 2000 mm

Eddy current type	
X	Conveyor belt suitable for EddyXpert
F	Conveyor belt suitable for EddyFines
Z	Special belt type

Conveyor belt material	
NBR	Rubber
PVC	PVC
PU	Polyurethane
Z	Special conveyor belt material

Belt thickness	
60	6,0 mm
30	3,0 mm
24	2,4 mm
Z	Special belt thickness



## Eddy current separator – Eddy current unit frame

REC-EF – 08 – X – L

Module	
REC-EF	Eddy current unit Frame
RECZ-EF	Special Eddy current unit Frame

Applicable for working width [dm]	
06	For belt width 600 mm
08	For belt width 800 mm
10	For belt width 1000 mm
15	For belt width 1500 mm
20	For belt width 2000 mm

Eddy current type	
X	EddyXpert frame
F	EddyFines frame
Z	Special frame

Motor position	
L	Left (seen in transport direction)
R	Right (seen in transport direction)

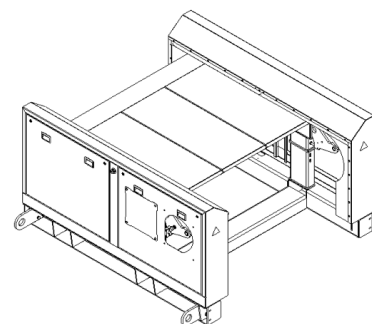

## Eddy current separator – Eddy current unit electrical connection

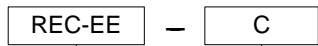

Module	
REC-EE	Eddy current unit Electrical connection
RECZ-EE	Special Eddy current unit Electrical connection

Connector socket type	
C	Connector plate with connector hubs
Z	Special connector

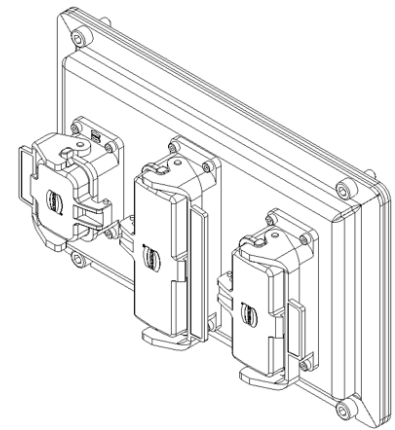

## Eddy current separator – Eddy current unit cover

REC-EC – 08 – X – N

Module	
REC-EC	Eddy current unit Cover
RECZ-EC	Special Eddy current unit Cover

Applicable for working width [dm]	
06	For belt width 600 mm
08	For belt width 800 mm
10	For belt width 1000 mm
15	For belt width 1500 mm
20	For belt width 2000 mm

Eddy current type	
X	EddyXpert frame
F	EddyFines frame
Z	Special frame

Suction flange connection size	
N	No suction flange, closed dust cover
D150	Diameter 150 mm
D250	Diameter 250 mm
Z	Special suction point

## Eddy current separator – Eddy current magnet roller

REC-MR – 06 – E38HI

Module	
REC-MR	Eddy current Magnet Roller
RECZ-MR	Special eddy current Magnet Roller

Applicable for working width [dm]	
06	For belt width 600 mm
08	For belt width 800 mm
10	For belt width 1000 mm
15	For belt width 1500 mm
20	For belt width 2000 mm

Magnet rotor type	
E12	Eccentric 12 poles
E22HI	Eccentric 22 High Intensity poles
E38HI	Eccentric 38 High Intensity poles

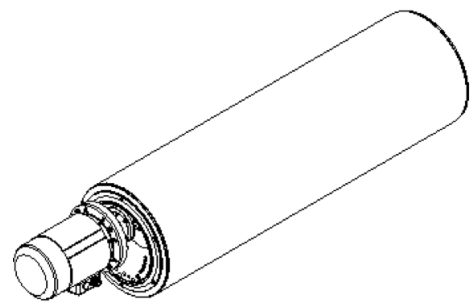

## Eddy current separator – Eddy current belt scraper

REC-ES – 08 – X – NBR

Module	
REC-ES	Eddy current belt Scraper
RECZ-ES	Special Eddy current belt Scraper

Applicable for working width [dm]	
06	For belt width 600 mm
08	For belt width 800 mm
10	For belt width 1000 mm
15	For belt width 1500 mm
20	For belt width 2000 mm

Eddy current type	
X	Belt scraper suitable for EddyXpert
F	Belt scraper suitable for EddyFines
Z	Special belt scraper type

Belt scraper material	
NBR	Rubber scraper tip
PU	PolyUrethane scraper tip
ST	Steel scraper tip
Z	Special scraper

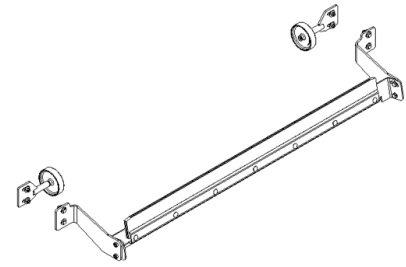

## Eddy current separator – Separation plate

REC-SP – 08 – FM

Module	
REC-SP	Separation Plate
RECZ-SP	Special Separation Plate

Applicable for working width [dm]	
06	For belt width 600 mm
08	For belt width 800 mm
10	For belt width 1000 mm
15	For belt width 1500 mm
20	For belt width 2000 mm

Separation plate type	
C	Coarse fraction separation plate
S	Standard (medium) fraction separation plate
FT	Fines fraction, Trespa separation plate
FM	Fines fraction, Mn steel separation plate
Z	Special separation plate

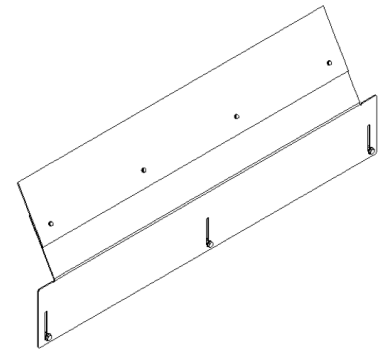

## Eddy current separator – Separation plate angle adjustment

REC-SA – M – L

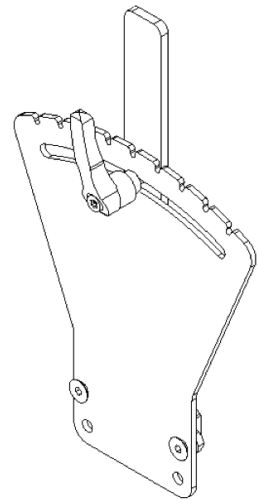

Module	
REC-SA	Separation plate Angle adjustment
RECZ-SA	Special Separation plate Angle adjustment

Separation plate angle adjustment	
M	Manually operated with lever
SM	Manually operated with spindle for Medium separation box
SL	Manually operated with spindle for Large separation box
E	Electrically operated
Z	Special angle adjustment

Separation plate adjustment side	
L	Left (seen in transport direction)
R	Right (seen in transport direction)
B	Both (left and right possible)

## Eddy current separator – Separation box

REC-SB – 08 – M – ST

Module	
REC-SB	Separation Box
RECZ-SB	Special Separation Box

Applicable for working width [dm]	
06	For belt width 600 mm
08	For belt width 800 mm
10	For belt width 1000 mm
15	For belt width 1500 mm
20	For belt width 2000 mm

Size	
M	Medium (standard size)
L	Large (for fractions with long particles)
Z	Special size

Inspection doors of separation box	
ST	Steel painted inspecion doors
PC	PolyCarbonate (transparent) inspection doors
Z	Special inspection doors

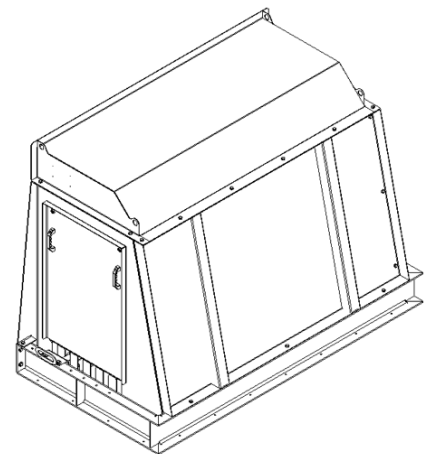



## Eddy current separator for non-ferro

### Change history

Date	Initiator	Tab	Description
28-11-2023	TK		EC separator   Separation unit: HPS / HPB / HPV / HBV added
			Conv. Feeder   Type: H replaced by: H170 / H300
			C.F. belt   Material feeder length: C20 replaced by: C170 / C300
			C.F. frame   Type: H replaced by: H170 / H300
			Vibr. Feeder frame   Type: HP added
19-01-2024	RM		All   Date and page numbers re-added
			EC separator   Page numbers (references) corrected