

REV	DATE	BY	DESCRIPTION
-	02.01.2018	LF	ORIGINAL DRAWING
A	13.03.2023	LF	BELT CLEATS 50mm (WAS 100), MOTOR IP55 (WAS IP54) REDUCTION IN THE NUMBER OF SPARE PARTS

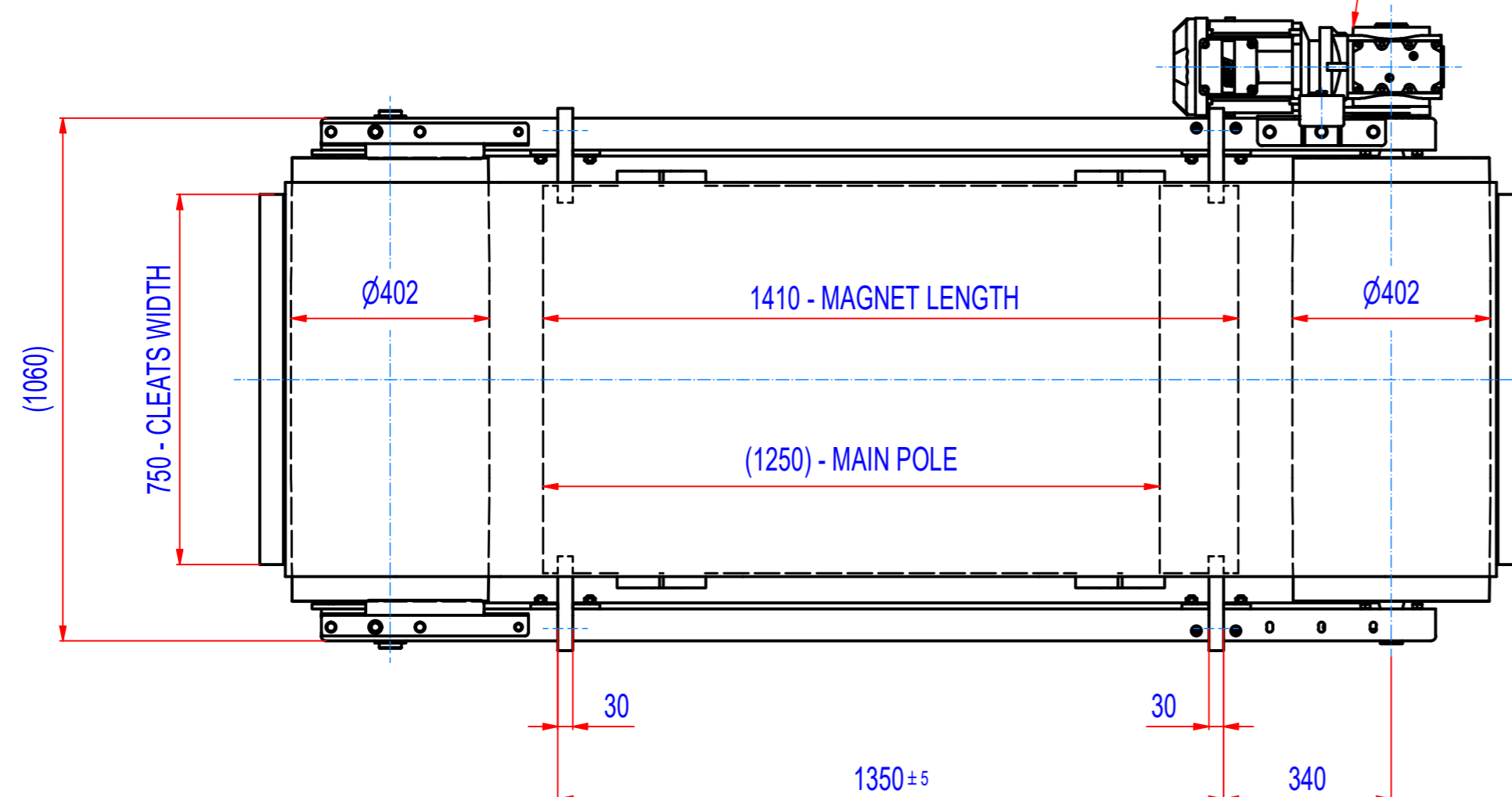
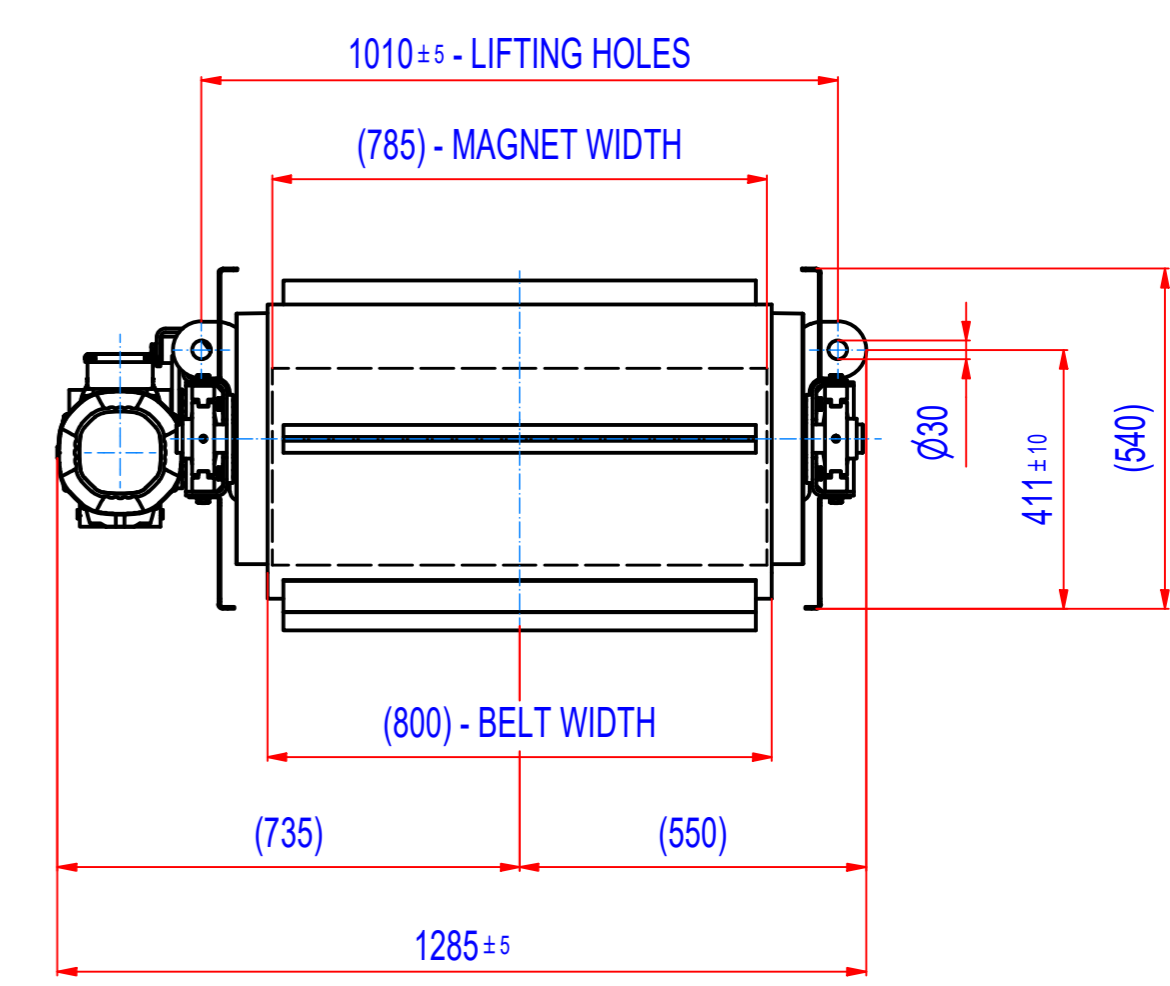
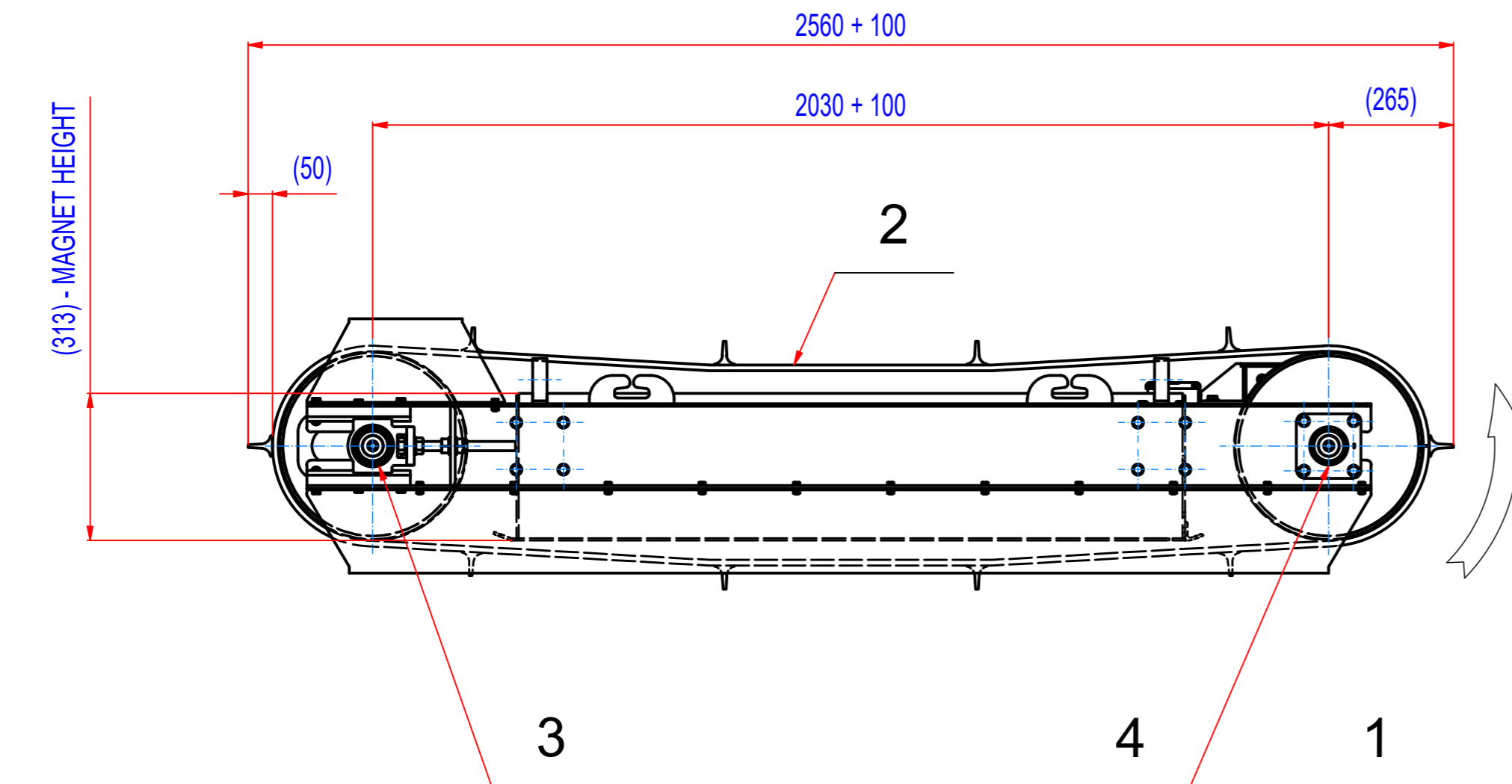

- GEARED BOX SEW SA67/TDRN100LS4; i=20,37 (71RPM);
 - MOTOR 230/400V; 2,2kW; 50Hz; IP55
 - ROLLER SPEED 71/min
 - BELT SPEED 1,5m/s
 - BELT EP500/4 5+2; LENGTH 5380, WIDTH 800,
 10 CLEATS T50/10, WIDTH 750

POZ.	Č. SOUČÁSTI	POPIS	MATERIÁL	HMOT.	MN.
4	15_8700045	BEARINGS ASSEMBLY INA PCJ 45		2,5	2
3	15_8600045	BEARINGS ASSEMBLY INA PTUE 45		2,7	2
2	45_4080040	BELT EP 500/4 5+2, W=800, L=5380	RUBBER	62	1
1	M022007132	SEW SA67/TDRN100LS4, 2,2kW, i=20,37 (71RPM)		59,2	1

Sheet: A2 Drawn: LF Date: 2.1.2018 Predecessor: SEPB120034 Quick search: XSPB 4 Description: SPARE PARTS FOR ROFC120340	Weight (kg): 1880,5 © All rights reserved. Reproduction is not permitted without written permission of GOUDSMIT Magnetic Systems BV	General tolerance: ISO 2768 - cL Drawn according: ISO268; ISO1101; ISO2553 Status: Customer reference number: Product key: ROP-F4-C-120-W-G-L-B-B-NA Part number: ROFC120340_SP Rev: -
--	---	---