

REV	BY	DATE	DESCRIPTION
-	LF	12.11.2017	REFERENCE OLD DRAWING ROFI120350_C
A	LF	23.03.2021	LIFTING HOLES d35 (WAS d30); BELT EP500/4 5+2 (WAS EP500/3 6+2); MOTOR IP55

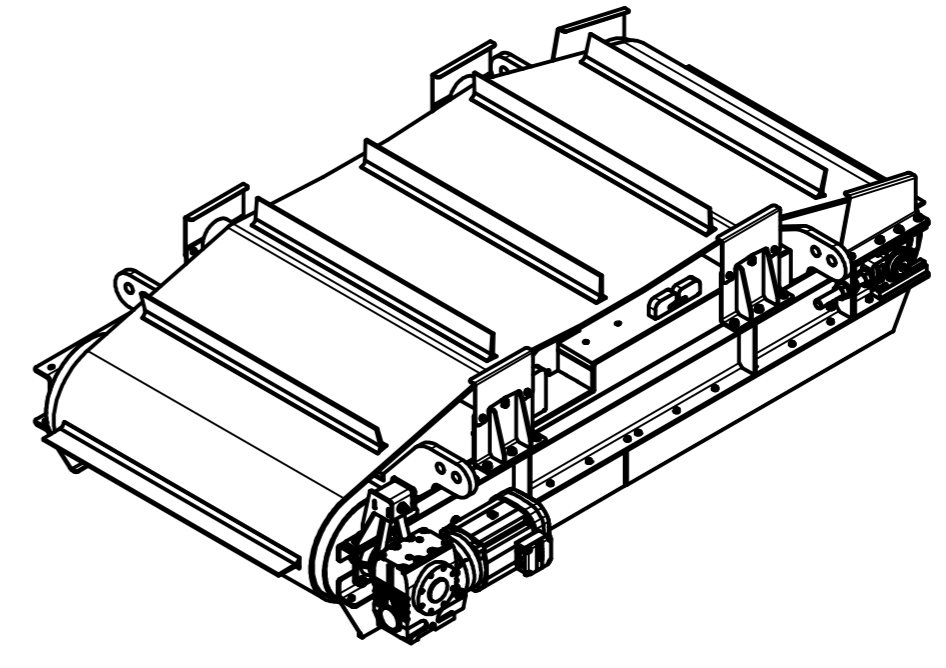
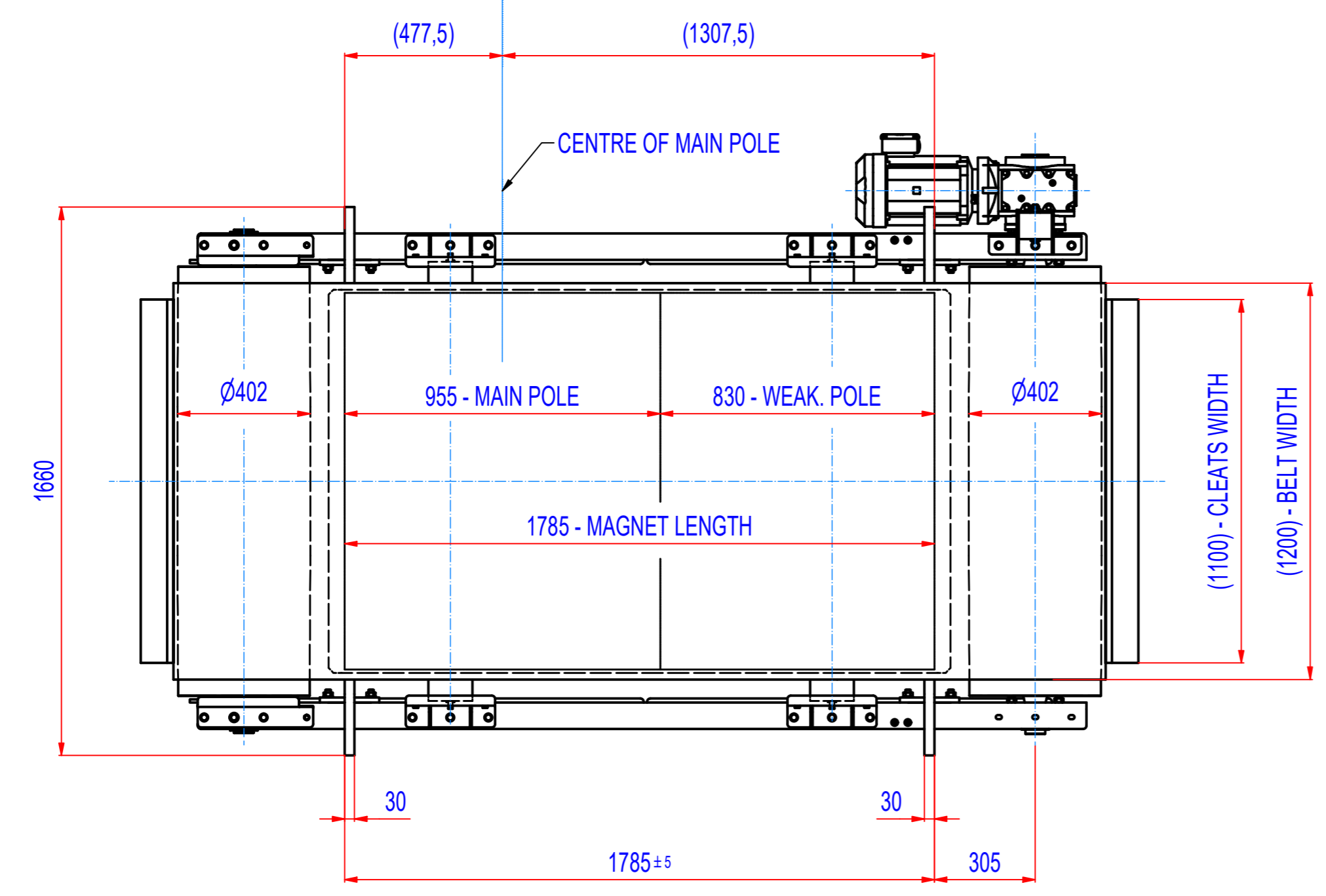
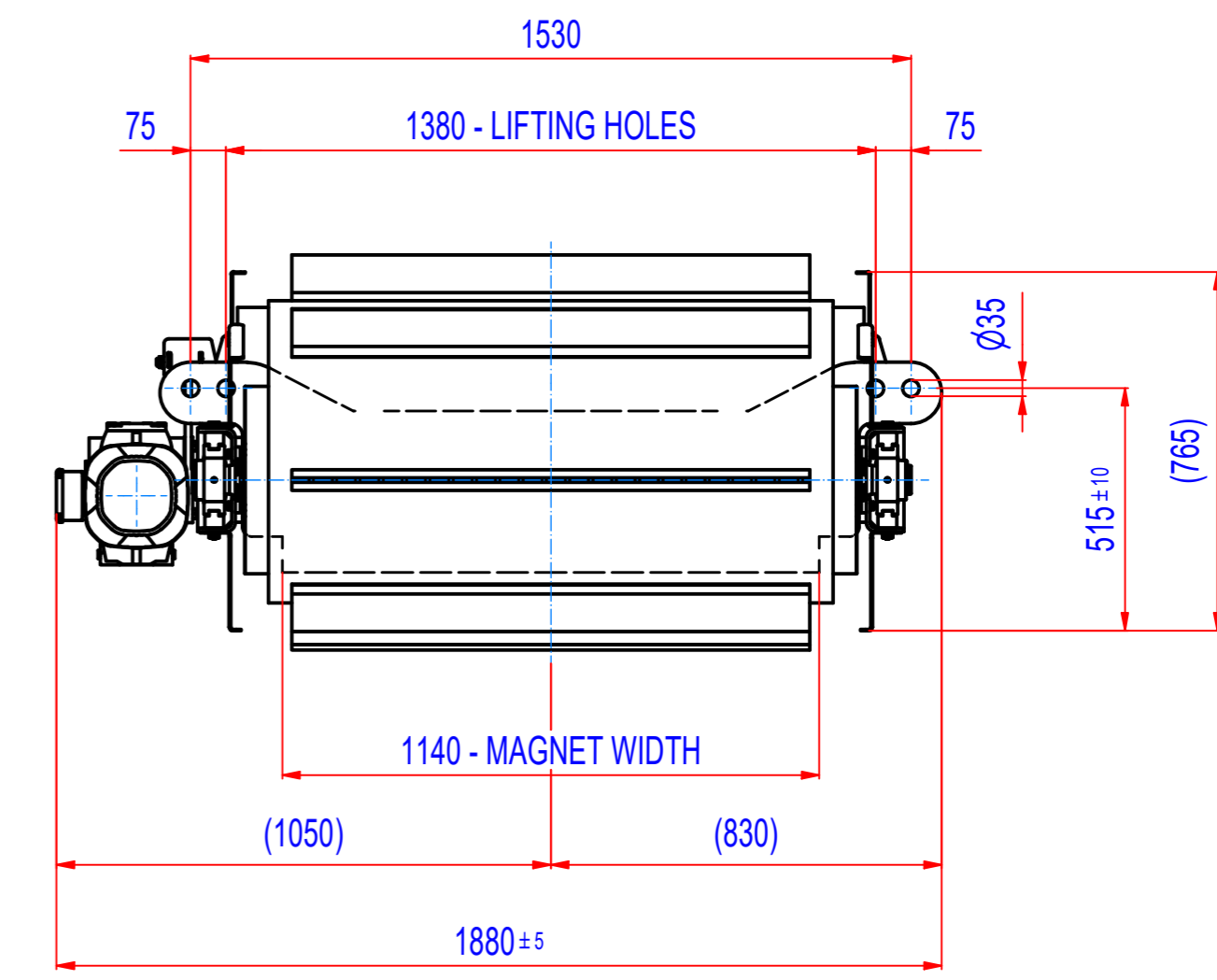
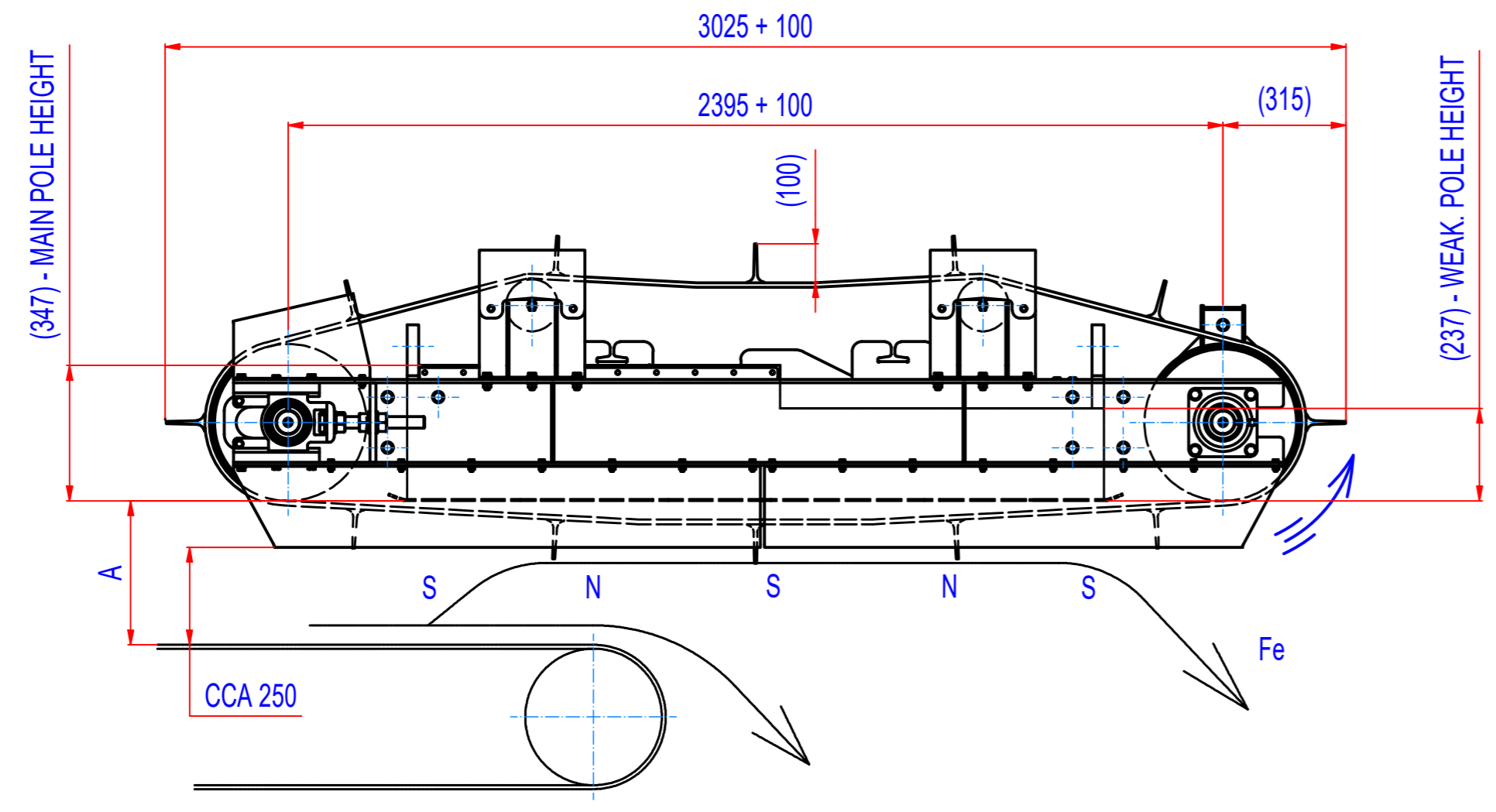

- GEARED BOX: SEW SA77/TDRN112M4, i=20,99 (70RPM), MOTOR 4kW, 230/400V, 50Hz, IP55
- DRUM SPEED 70 /min
- BELT SPEED 1,45 m/s
- BELT EP500/4 5+2, WIDTH 1200, LENGTH 6150, 12 CLEATS T100/10, WIDTH 1100

A = 430 mm - max. catch distance for rod Ø15, L=75 mm (VDE)  
A = 370 mm - 400 Gs

Sheet: A2	Extra info:	General tolerance: ISO 2768 - cL
Drawn: LF	Weight (kg): 3548	Drawn according: ISO268; ISO1101; ISO2553
Date: 12.11.2017		Status:
Predecessor:		Customer reference number:
Quick search: XSPB 5	© All rights reserved. Reproduction is not permitted without written permission of GOUDSMIT Magnetic Systems BV	Product key: ROP-F5-I-120-W-G-L-B-B-NA
Description: Overband separator, Ferrite, Size 5, W1200, Inline		Part number: ROFI120350
		Rev: A