

REV	BY	DATE	DESCRIPTION
-	LF	12.11.2017	REFERENCE OLD DRAWING ROFI120350_C
A	LF	23.03.2021	LIFTING HOLES d35 (WAS d30); BELT EP500/4 5+2 (WAS EP500/3 6+2); MOTOR IP55 22.10.2023 - REDUCTION IN NUMBER OF SPARE PARTS

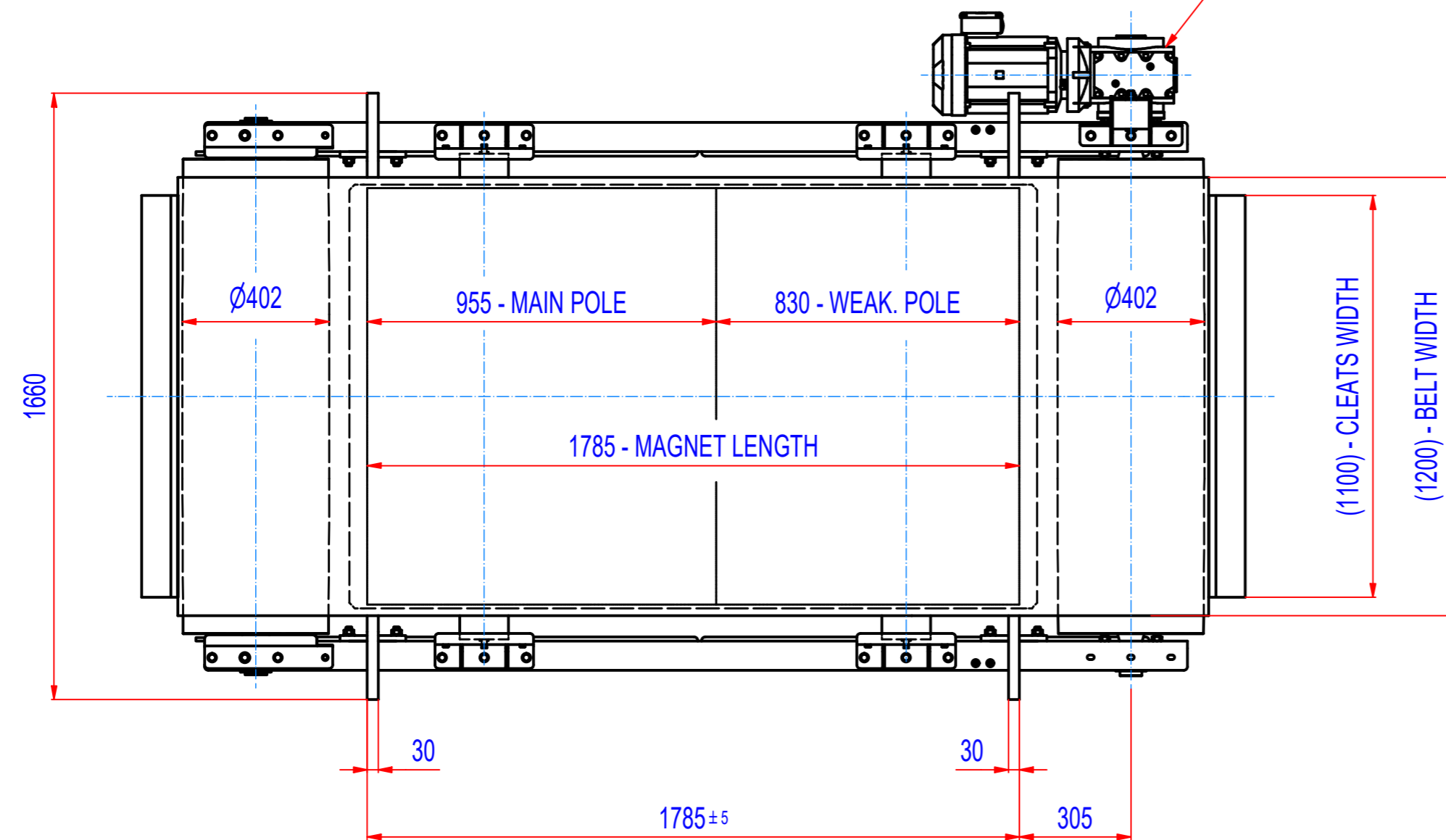
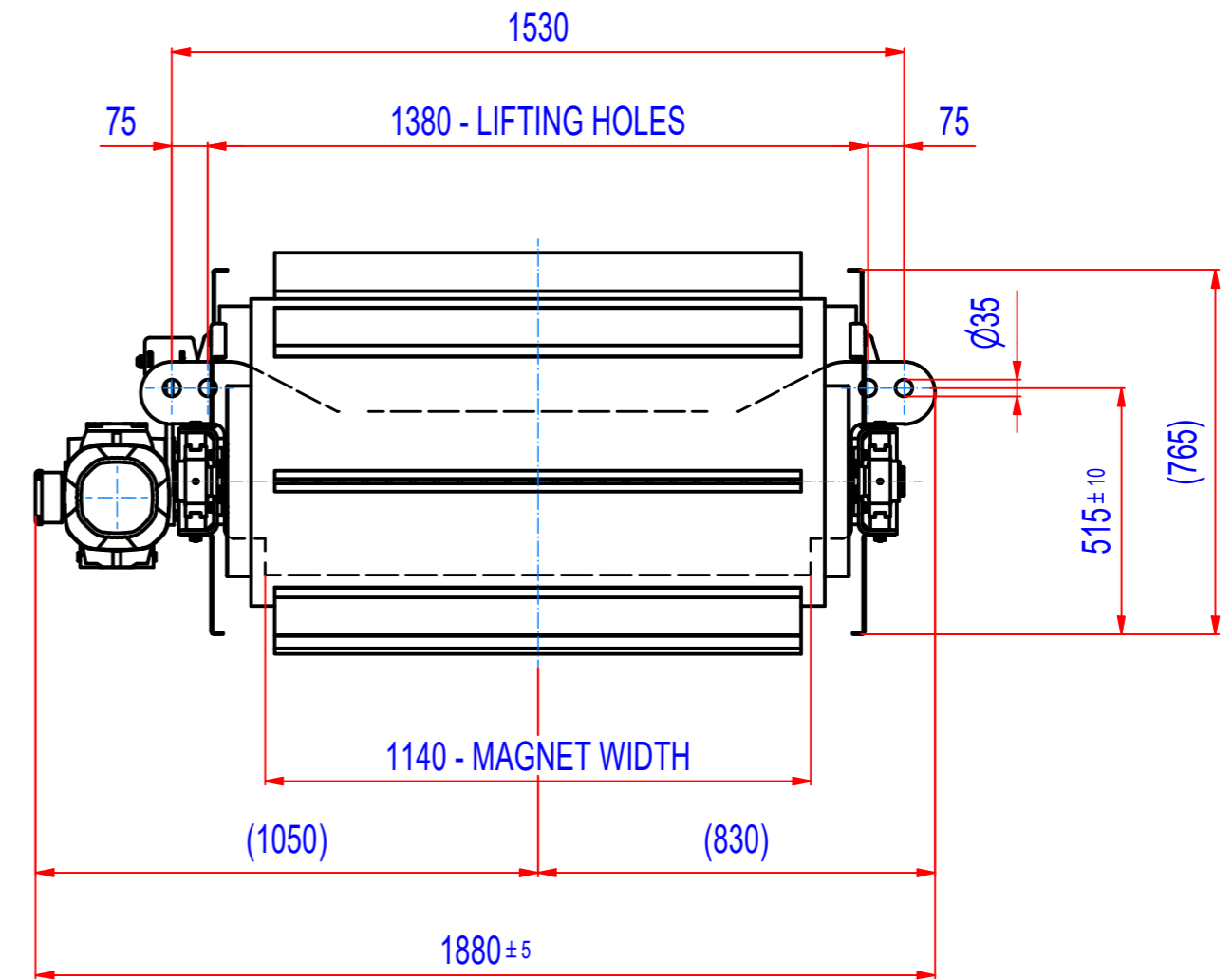
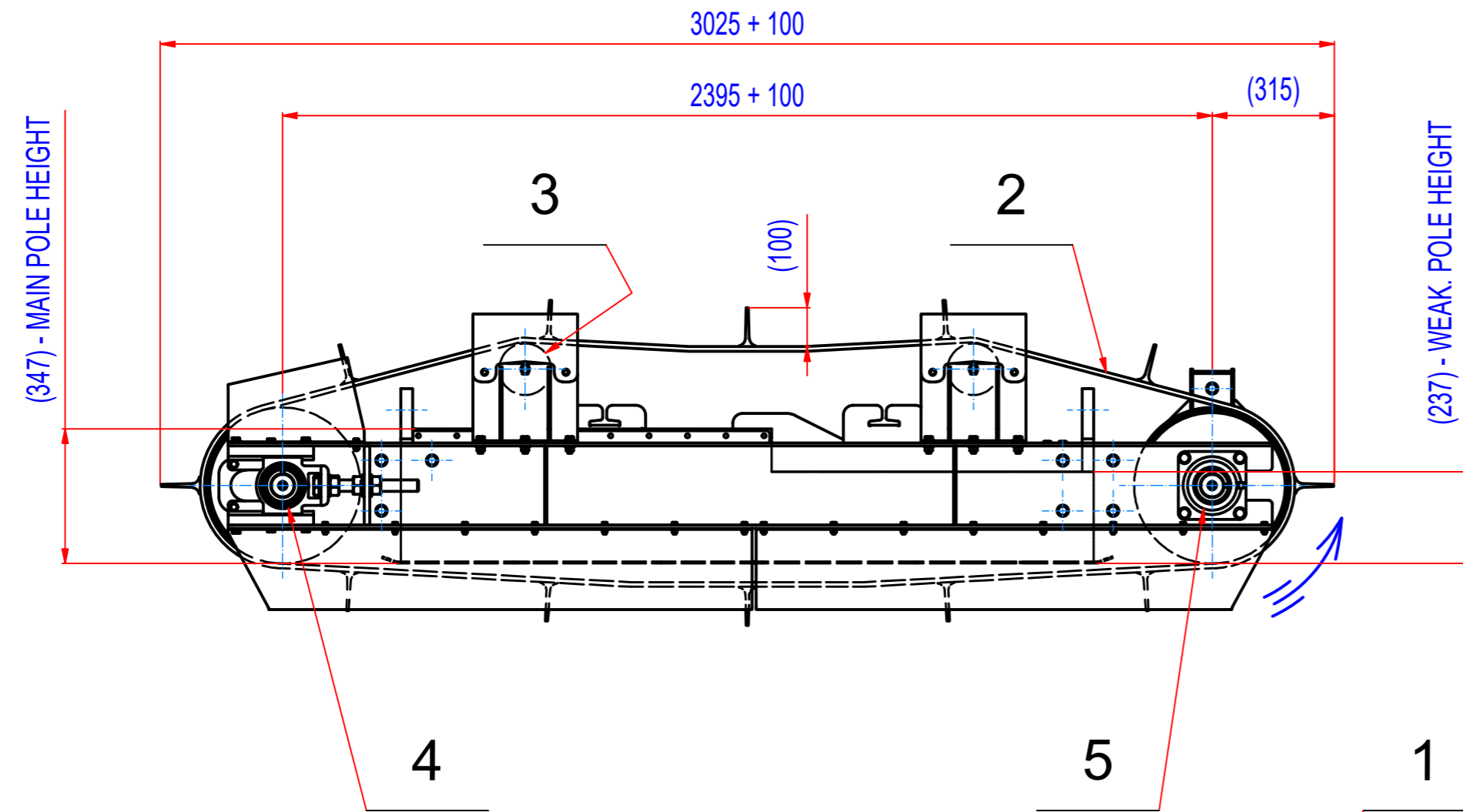

- GEARED BOX: SEW SA77/TDRN112M4, i=20,99 (70RPM), MOTOR 4kW, 230/400V, 50Hz, IP55
- DRUM SPEED 70 /min
- BELT SPEED 1,45 m/s
- BELT EP500/4 5+2, WIDTH 1200, LENGTH 6150, 12 CLEATS T100/10, WIDTH 1100

POZ.	Č. SOUČÁSTI	POPIS	MATERIÁL	HMOT.	MN.
5	15_8700060	BEARINGS ASSEMBLY INA PCJ 60		4,1	2
4	15_8600060	BEARINGS ASSEMBLY INA PTUE 60		4,3	2
3	1510_00053	PLAIN ROLLER d=133, L=1330		27	2
2	45_4120035	BELT EP500/4 5+2, W 1200, L 6150	RUBBER	129	1
1	M040007012	SEW SA77/TDRN112M4, 4kW, i=20,99 (70RPM)		91,6	1

Sheet: A2	Extra info:	Počet listů: 1/1	General tolerance: ISO 2768 - cL
Drawn: LF	Weight (kg): 3548		Drawn according: ISO268; ISO1101; ISO2553
Date: 12.11.2017			Status:
Predecessor:			Customer reference number:
Quick search: XSPB 5			Product key: ROP-F5-I-120-W-G-L-B-B-NA
Description: NÁHRADNÍ DÍLY / SPARE PARTS ROFI120350			Part number: ROFI120350_ND
			Rev: A



© All rights reserved. Reproduction is not permitted without written permission of WAMAG, spol. s r.o.