

REV	DATE	BY	DESCRIPTION
-	17-6-2013	CR	NEW REVISION VAULT, NOTHING CHANGED, OLD REV WAS C
A	5-4-2016	CR	ITEM 2 & 3 ADDED
B	3-3-2022	AvD	E0028964 AND 70.4200006 MOVED TO UNDERLYING DRAWING, TYPE PLATE ADDED, MATERIAL CHANGED INTO AISI316L, PRODUCT KEY CORRECTED.

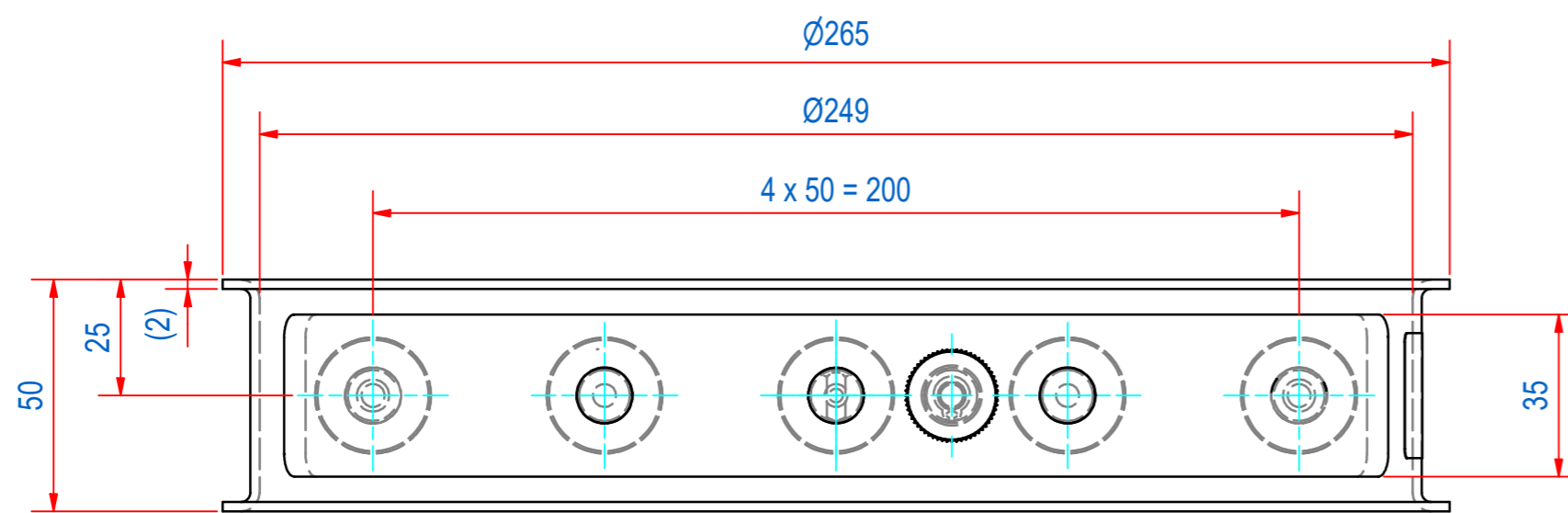

ITEM	QTY	PART NUMBER	DESCRIPTION	Dimensions
4	1	E0150280	STICKER MAGN FIELD 30MM SMR-JF-D250	
3	1	E0150258	TYPE PLATE SMR-JF-D250-HOUSE	
2	1	E0150257	TYPE PLATE SMR-JF-D250-INSERT	
1	1	A250492	SMR-N-D250x50-JF-05E GRID ASSY	

RAW MAT.	Quantity: 1	Material Number:	Material Description:	Length (mm):	Width (mm):
Sheet:	A2	Extra info:	MAGNETIC GRID	General tolerance:	ISO 2768 - mK
Drawn:	JH	Weight (kg):	4,5	Drawn according:	ISO286; ISO1101; ISO2553
Date:	16-4-2009	Status:	Standard	Customer reference number:	
Spare part:	False	Source:	MC-C	Document number:	SEMR025078
Quick search:	MRNB0250	Doc.Rev:	B	Part number:	SEMR025078
Description:	SMR-N-D250x50-JF-05E-S6-S			Rev:	B

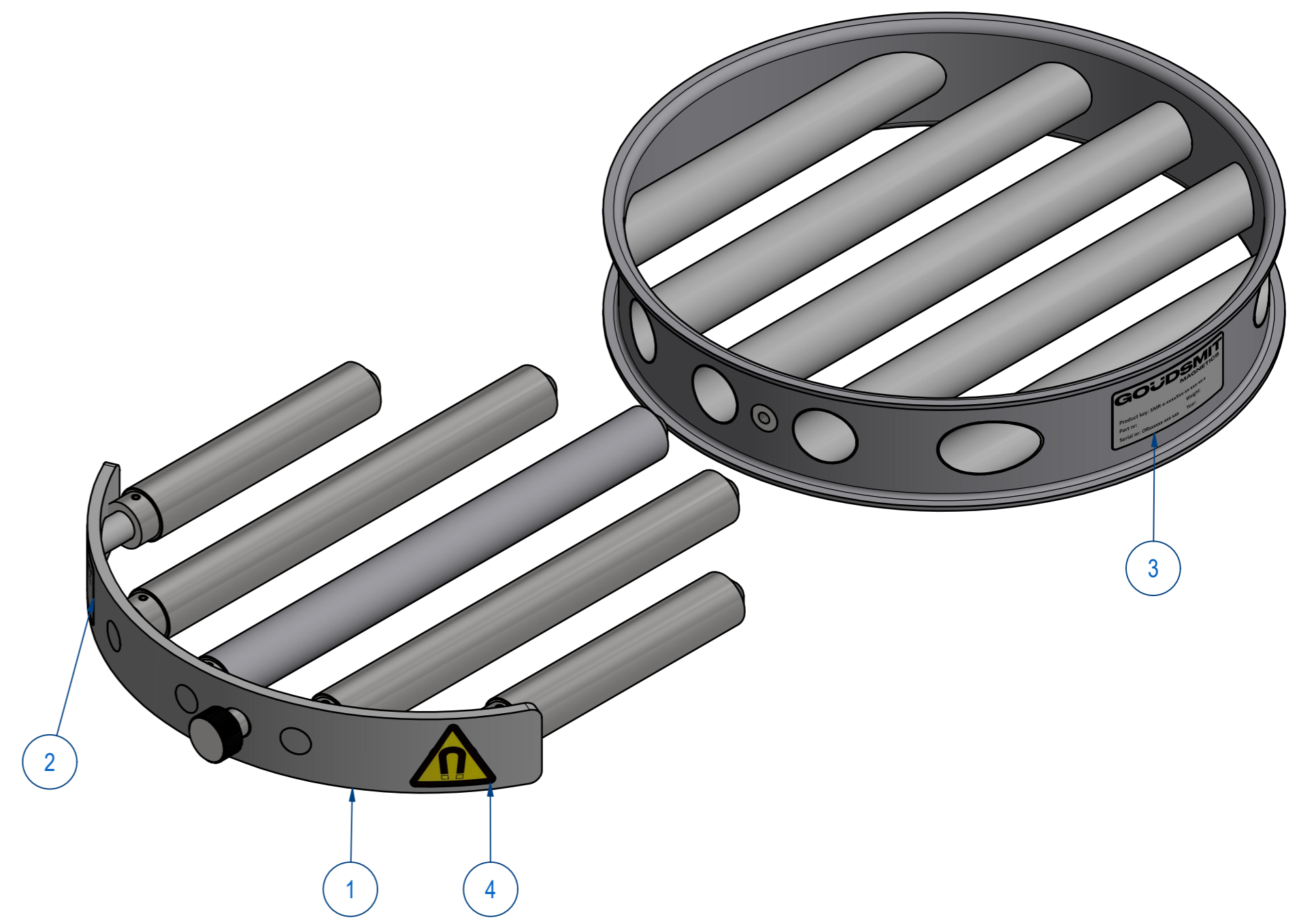
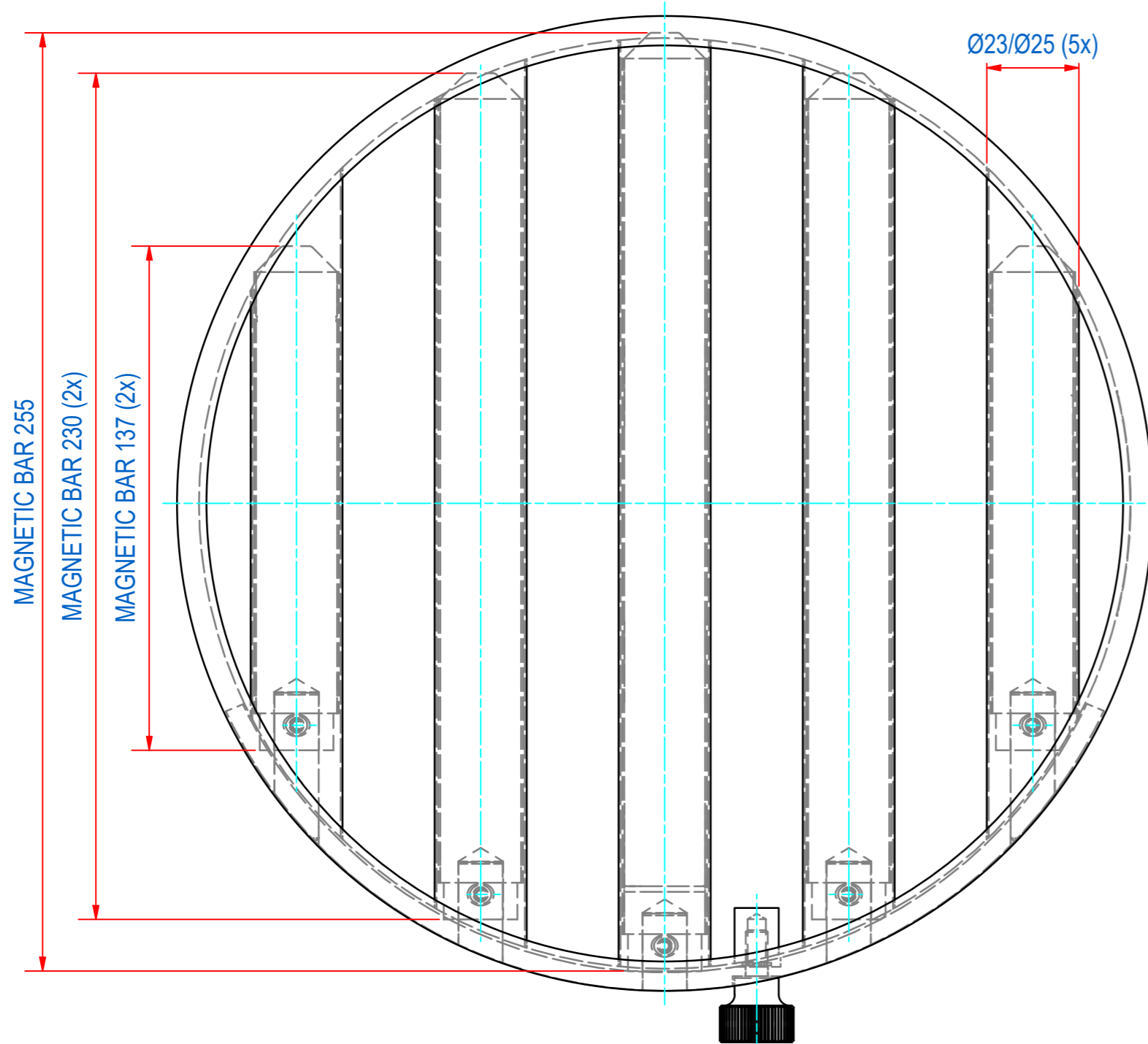