

REV	DATE	BY	DESCRIPTION
-	4-9-2014	CR	NEW REVISION VAULT, NOTHING CHANGED, OLD REV WAS D
A	25-1-2018	CR	MAGNETIC BAR (3x), TYPE PLATE AND WARNING STICKERS ADDED
B	19-10-2020	CR	UNDERLYING DRAWING LASER WELDED

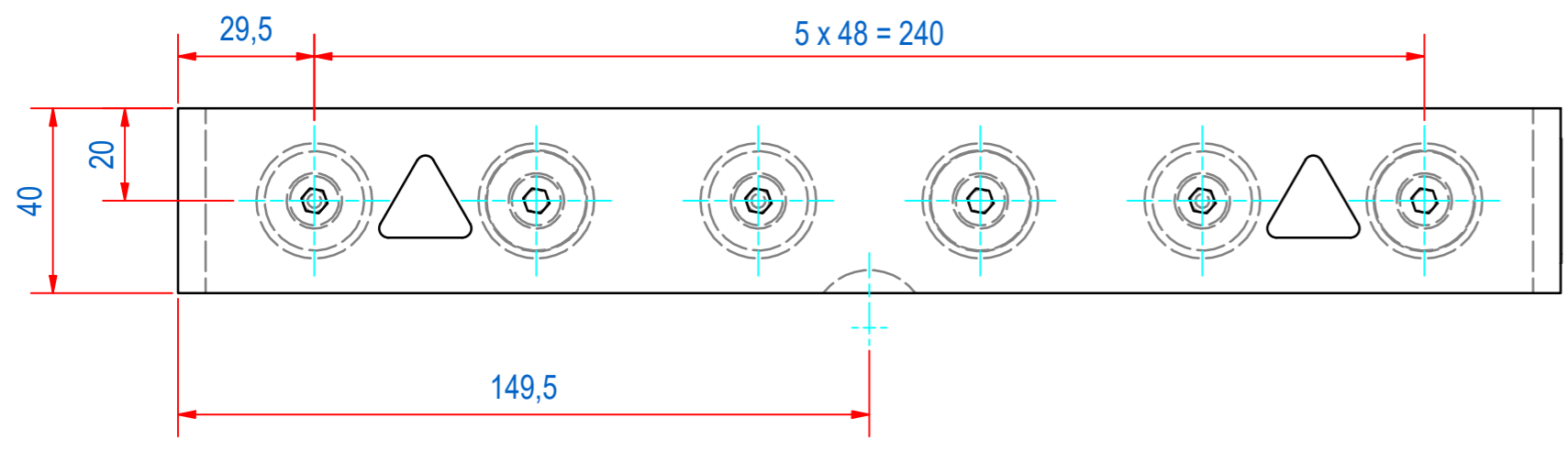
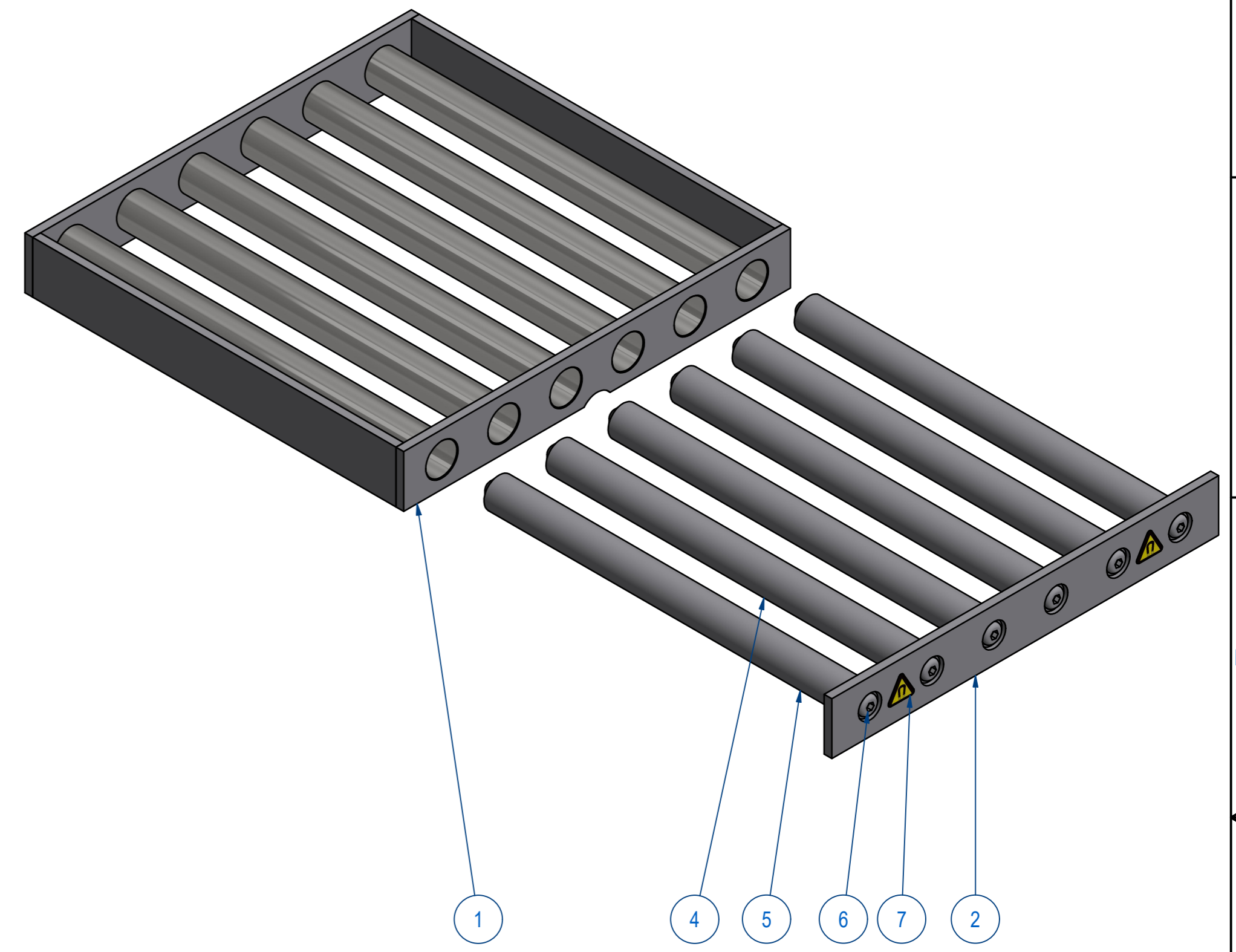
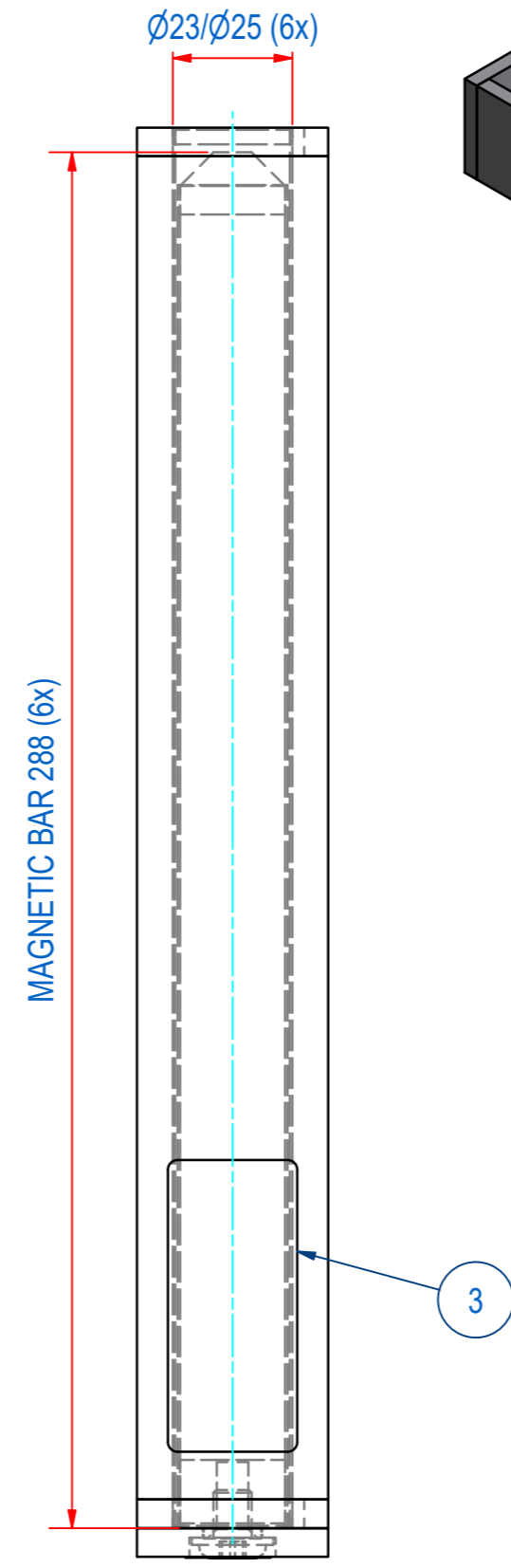
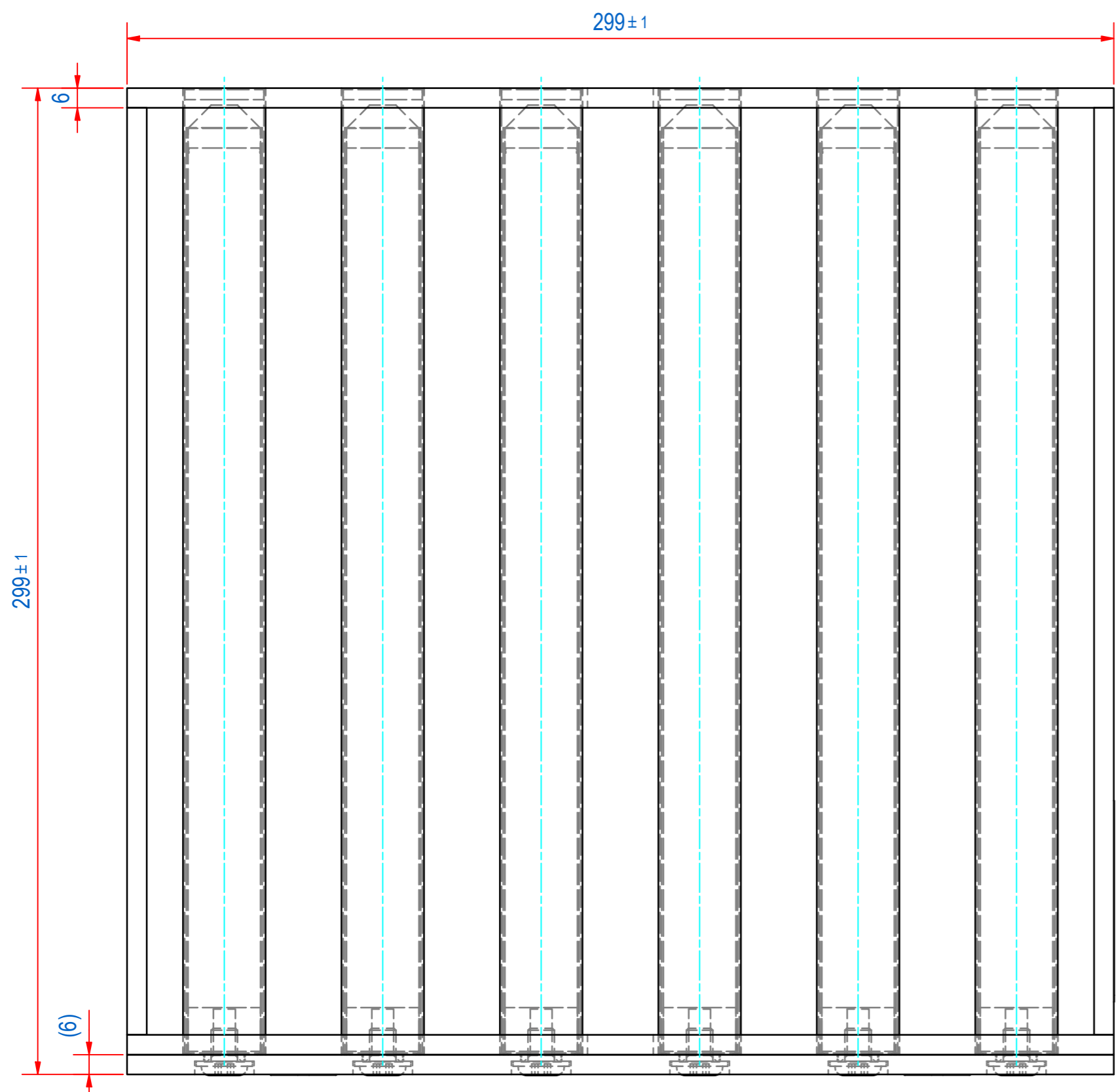

ITEM	QTY	PART NUMBER	DESCRIPTION	Dimensions
7	2	1000.20080	STICKER MAGNETIC FIELD 20mm	
6	6	54.9208010	SCR HEX S HC FL M08x10 AISI304	
5	3	SBAMB100039-288	BAR-N-23-290-25-CM8-NH-N	
4	3	SBAMB100030-288	BAR-N-23-290-25-CM8-NW-N	
3	1	E0086577	TYPE PLATE SQUARE GRID SMR	
2	1	S240057	FRONT MAGNET STRIP 40x6 L299	
1	1	A240029	SMR-EXTRACTOR #299x40 6B 316L	

RAW MAT.	Quantity	Material Number	Material Description	Length (mm)	Width (mm)
1	1				

Sheet: A2 Drawn: MSE Date: 8-12-2000 Spare part: False Quick search: MRNB3030	Extra info: MAGNETIC GRID Weight (kg): 8,5 Source: MC-C Description: SMR-N-0300x300x40-06E-S6-B	General tolerance: ISO 2768- mK Drawn according: ISO286; ISO1101; ISO2553 Status: Standard Customer reference number: Document number: SEMR303038 Doc.Rev: B Part number: SEMR303038 Rev: B
--	--	---