

REV	DATE	BY	DESCRIPTION
-	7-8-2013	BS	ORIGINAL DRAWING
A	4-1-2023	DK	SOURCE CODE ADDED, TYPE PLATE STICKER ADDED
B	30-1-2023	DK	VIEWS UPDATED

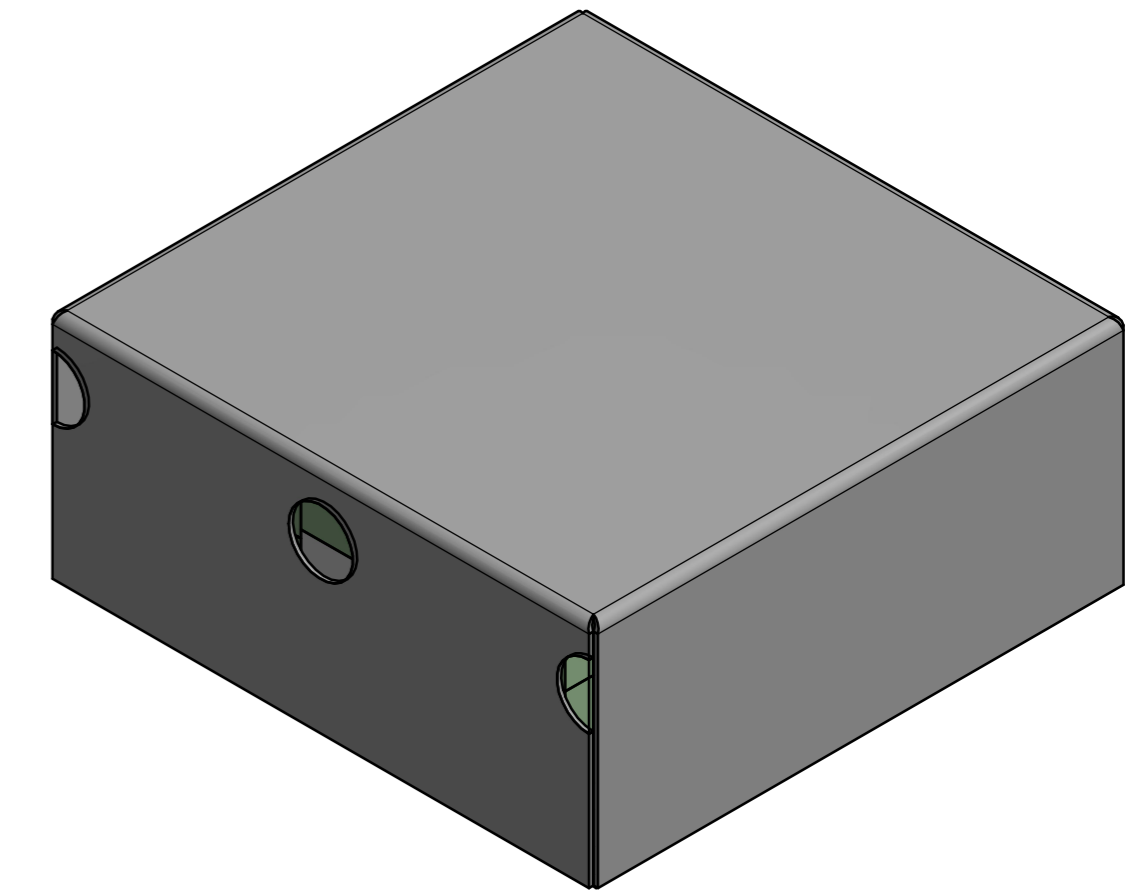

ITEM	QTY	PART NUMBER	DESCRIPTION	Dimensions
2	1	E0156683	HRA-TYPE PLATE ETCH	
1	1	E0157131	HRA-WELD AND MOULD ASSY	
RAW MAT.	Quantity	Material Number	Material Description	Length (mm) Width (mm)
	1			
Sheet: A2		Extra info: Reinforced Watertight AISI		General tolerance: ISO 2768- mK
Drawn: BS		Weight (kg): 2,8		Drawn according: ISO268; ISO1101; ISO2553
Date: 6-8-2013		Source: MC-C		Status: Standard
Spare part: False		Quick search: TBAA54		Customer reference number:
Description: HRA-F-102x44-AA-0100-R-W		Part number: TBAA010054		Doc.Rev: B
				Rev: B

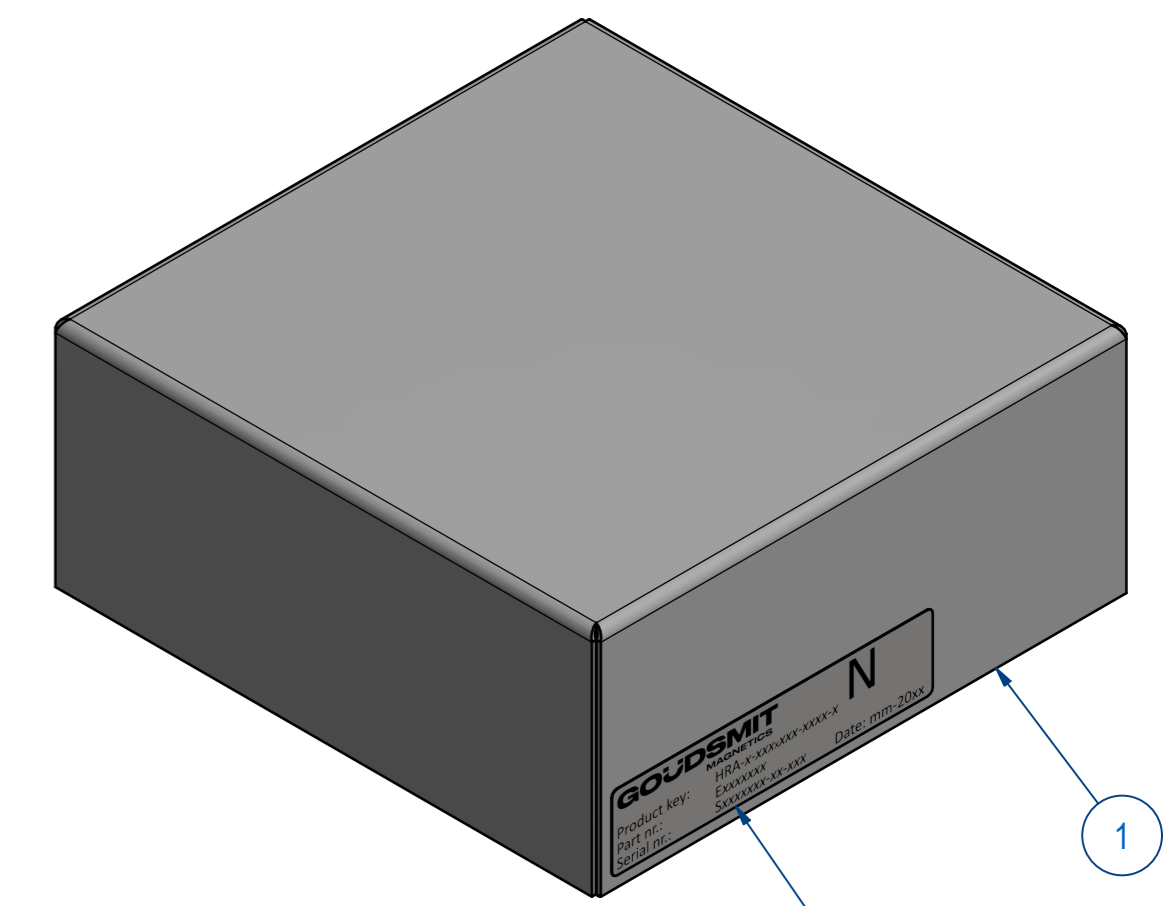
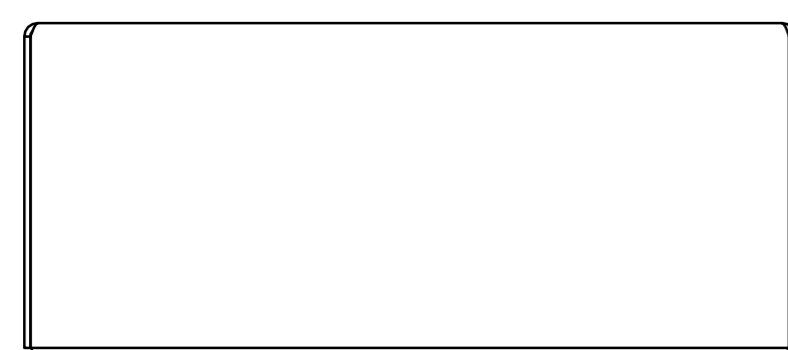
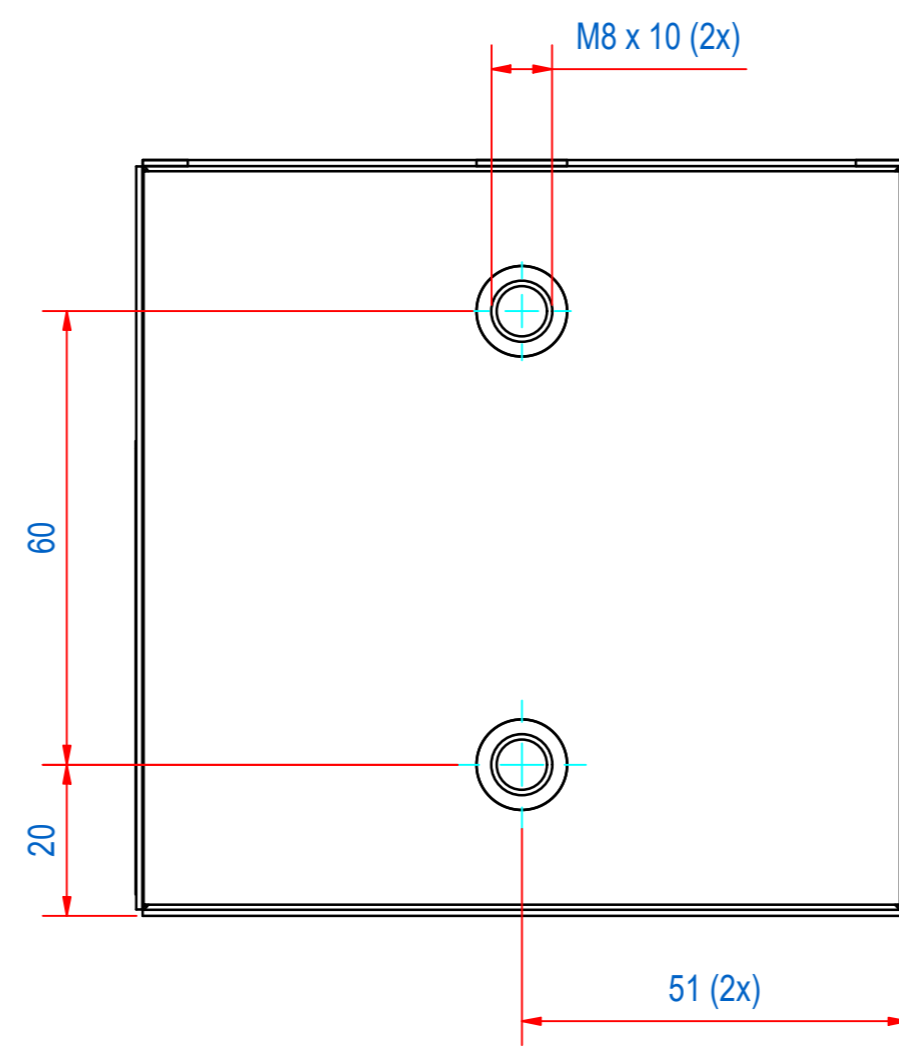
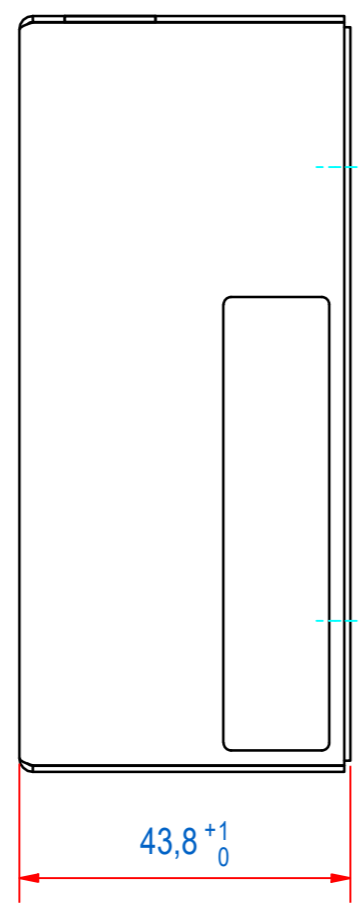
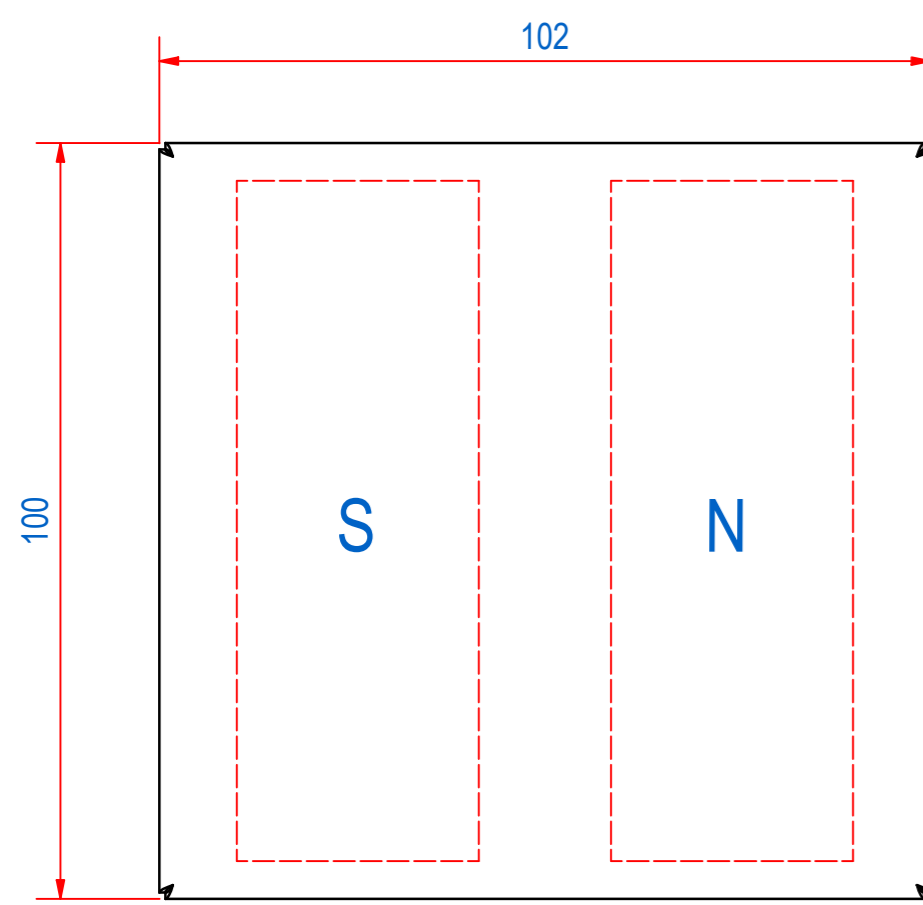
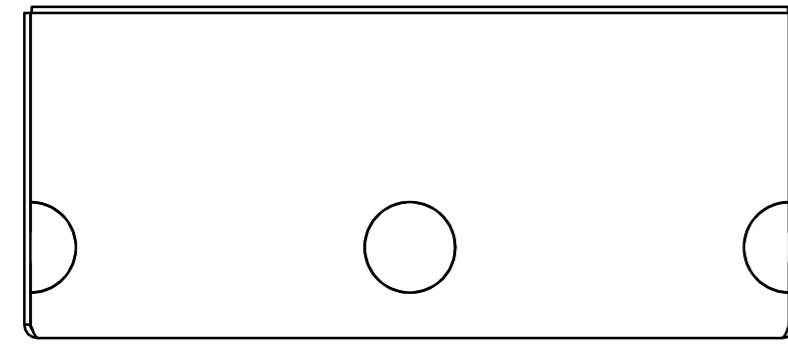

© All rights reserved. Reproduction is not permitted without written permission of GOUDSMIT Magnetic Systems BV